



GS HABITAT

MODULAR HOUSE

Guangdong Guose Building Technology Group Co., LTD

GUANGZHOU OFFICE ADDRESS : Room 311, Huayue Building, 423 Xicha Road,
Baiyun District, Guangzhou City, Guangdong Province

FACTORY ADDRESS : No. 21, Linjiang Avenue, Yong'an Industrial Park, Dinghu
District, Zhaoqing City, Guangdong Province

COMPANY CONTACT : SHIRLEY
CONTACT NUMBER : +86-13512762486



>> ABOUT US



Guangdong Goose Building Technology Group Co., LTD is a professional steel structure company. It was established in 1996 and is located in Zhaoqing City, Guangdong Province. It has a large-scale production and R&D base of over 100,000 square meters, a 30,000 square meter product display center, and a 50,000 square meter storage center.

Goose is committed to becoming a leading modular building comprehensive service provider at home and abroad. It provides OEM services to many international brands in the field of residential construction, self-produced and self-sold, exported to more than 50 countries and regions, and landed more than 1,000 projects. There are many well-known cases in Australia, the United States, the Philippines, Israel, Nigeria, Japan and other countries. As a high-end prefabricated house manufacturer, Goose advocates design-enabled products, comprehensively creates prefabricated, high-turnover, and more environmentally friendly prefabricated buildings, and provides customers with one-stop brand services and personalized solutions from planning, design, manufacturing, transportation, to construction.



GOOSE GROUP WHOLLY-OWNED AND SELF-BUILT-ZHAOQING NEW FACTORY

>> ABOUT US

Marketing Center



The marketing center is located in Huayue Building, Baiyun District, Guangzhou. It consists of foreign trade business department, operation department, art design department, shipping and customer service personnel, focusing on market research, brand promotion and sales channel expansion to ensure the competitiveness of products in domestic and foreign markets.

Product Exhibition Center



Product Exhibition Center - Yunshu Campsite, located in Xianlu Island, Nanhai District, Foshan City, covers an area of 30,000 square meters and is one of the largest mobile house product display centers in Guangdong Province.

Company Honors

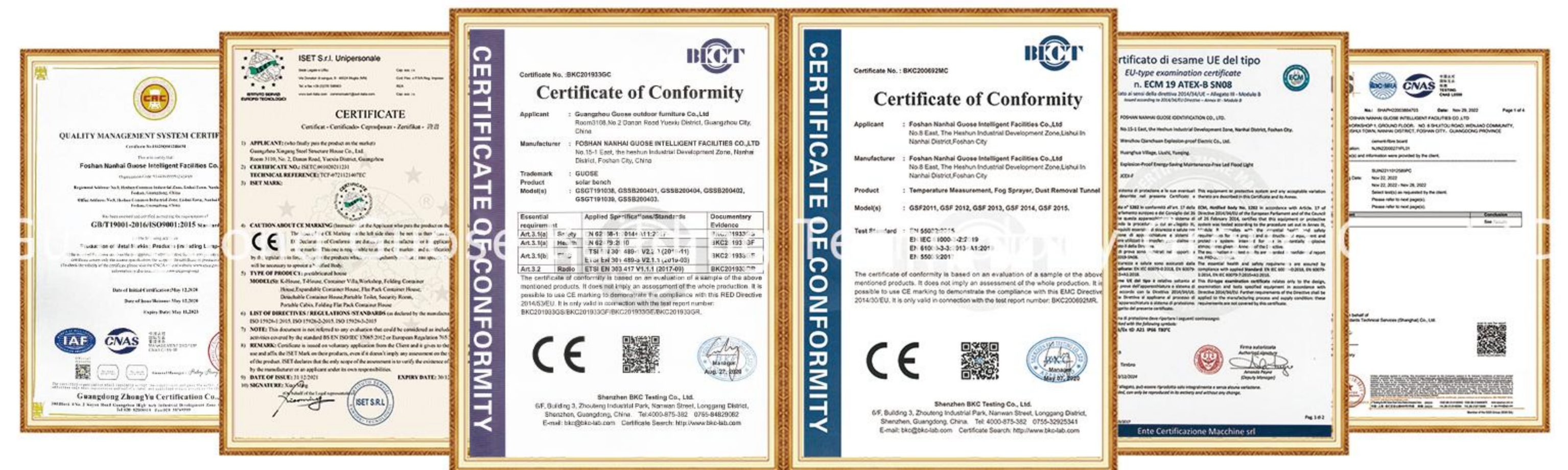

Patent Certificate 18+

Guose attaches great importance to trademark and patent protection, and safeguards the legitimate rights and interests of enterprises and consumers.

Certificate of Honor 80+

Guose strictly implements standardized production, and its products can withstand strict quality inspection processes.

Material Certification 34+

Guose products meet export standards and have obtained material standard certification from multiple countries



Modular house concept

Modular house is a new form of house construction that divides the components of the house into different functional modules, realizes factory manufacturing through standardization, modularization, and generalized production, and can be quickly assembled on site.

Modular house advantages

1. Faster construction speed compared to traditional house construction methods
2. Higher precision and quality stability, better quality control
3. Flexible combination and customized design of modules according to different needs
4. Shortened construction period can reduce labor costs and better economy



Resistant to typhoons
Level **15 -17**



Resistant to earthquakes
Level **10 or above**



Roof pressure reach
280kg/sq



Single module **Not**
More than 50kg



Each board can bearing
capacity **8-10** people

High-quality modular



Modular houses are made up of multiple pre-manufactured modules, which can be different building components such as walls, floors, roofs, stairs, etc. Each module is produced in the factory according to strict standards and processes to ensure its quality and dimensional accuracy.

High-quality modular panels



The size of a standardized modular panel is **1220mm**. The size of a modular house can be customized according to customer needs and is composed of multiple standardized modular panels

Toilet Module



High quality toilet module

Independent modules

Integrated sanitary ware

Can be moved by forklift

Power on and you can use it

Flooring composition



Wall structure

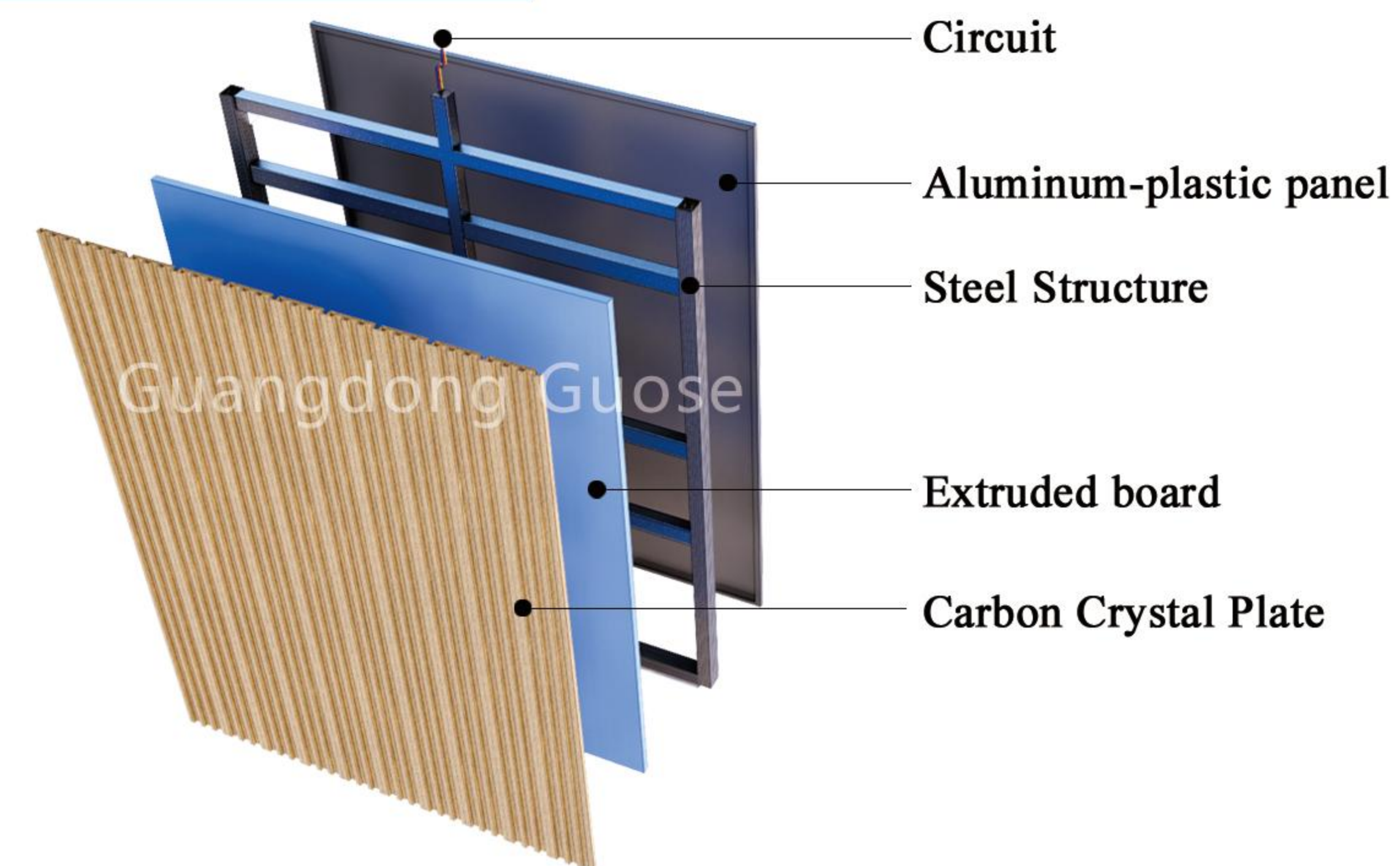

Roof structure

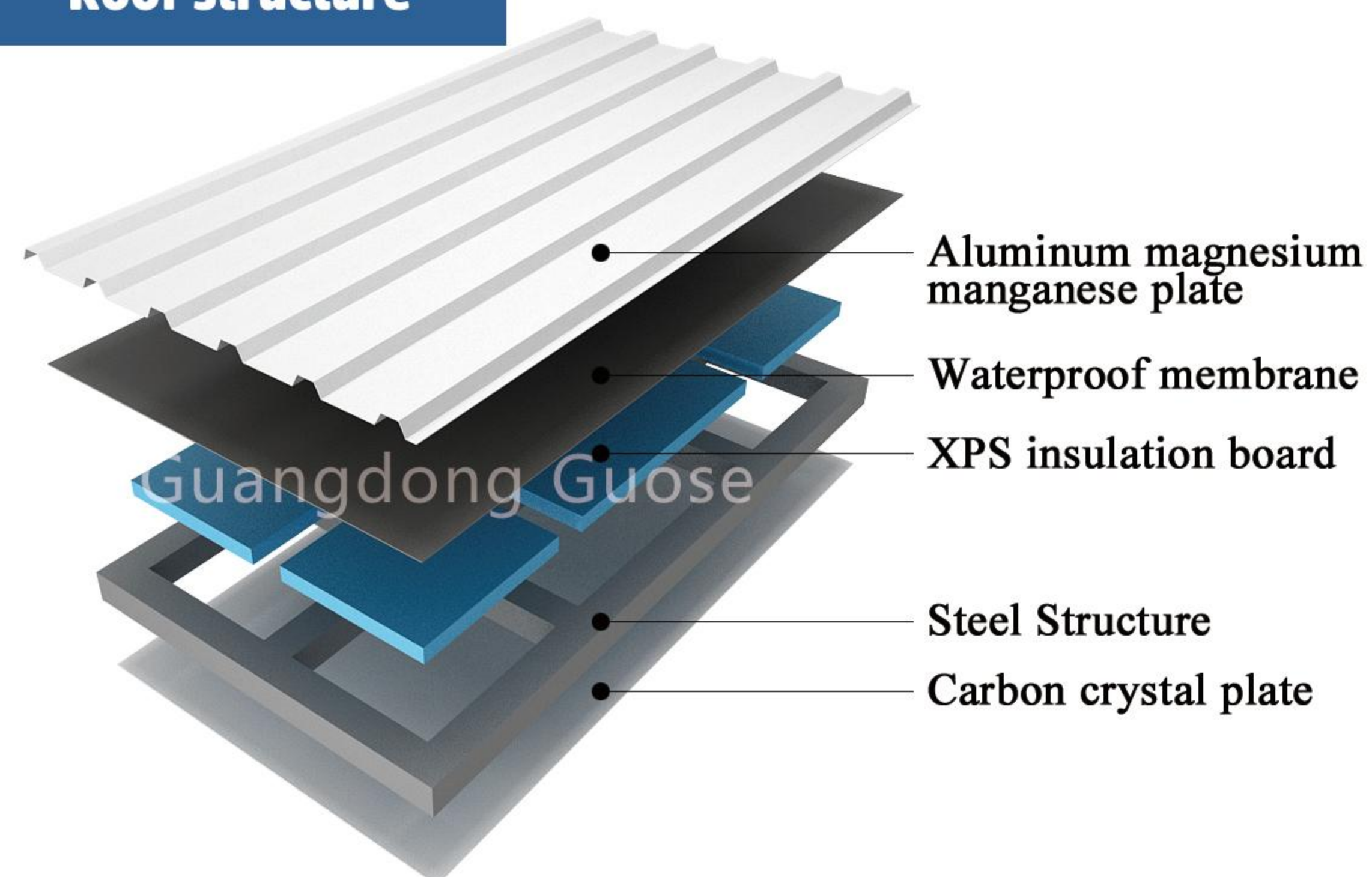

Roof structure

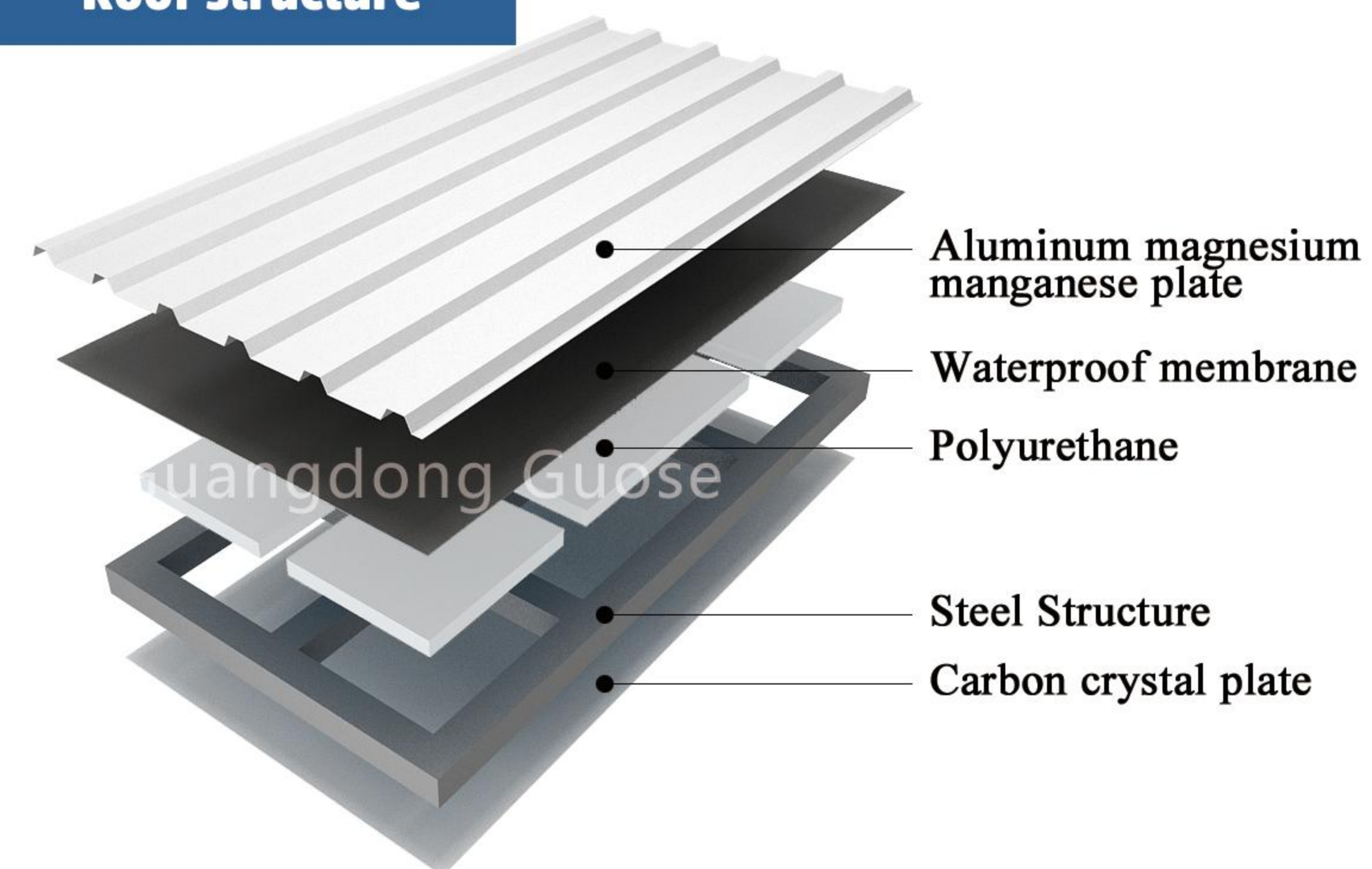

Packaging and Shipping



Modularization can achieve efficient space utilization, transport multiple modules at a time, improve transportation efficiency, and minimize freight and reduce costs.

MODULAR HOUSE-MH00

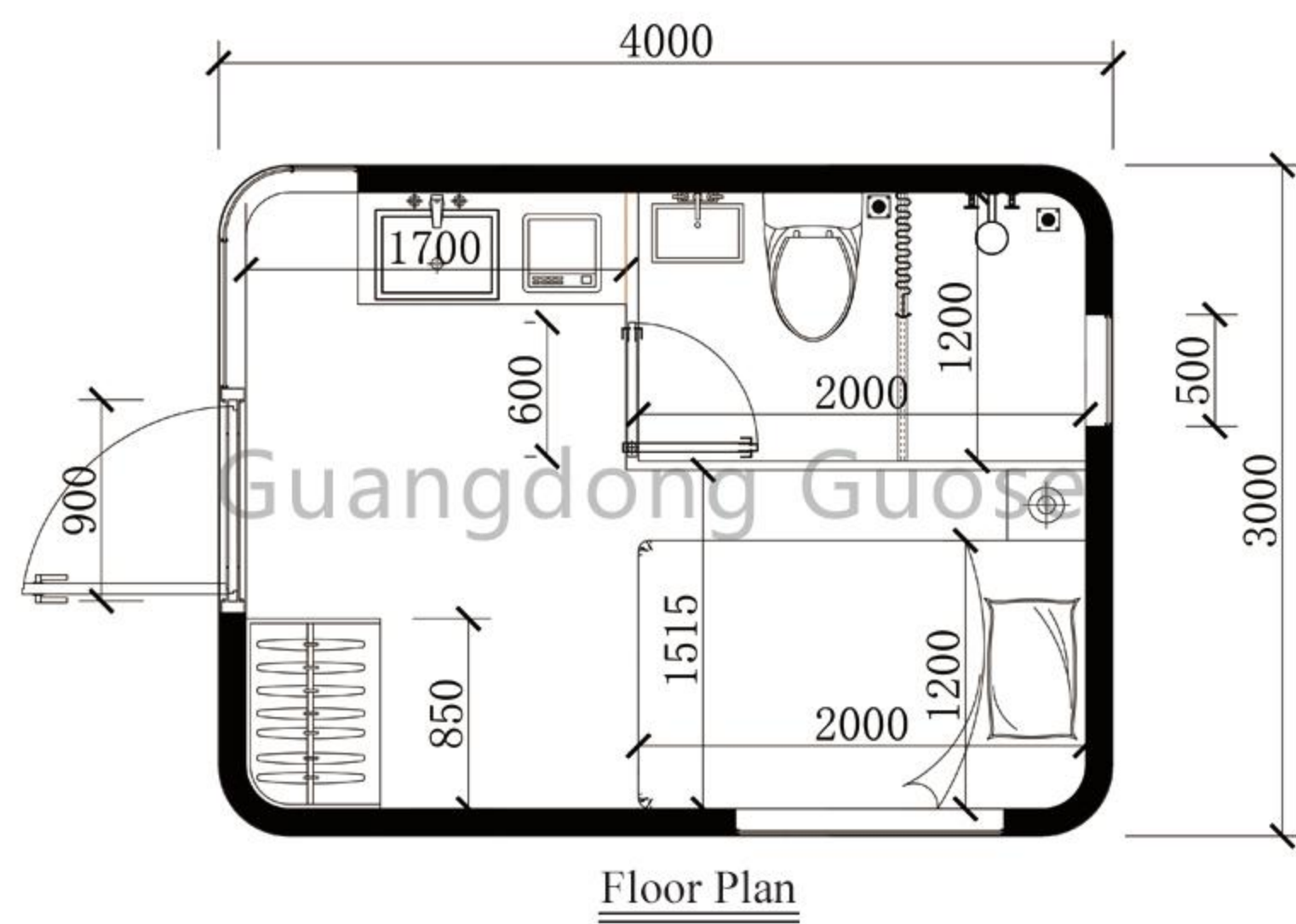
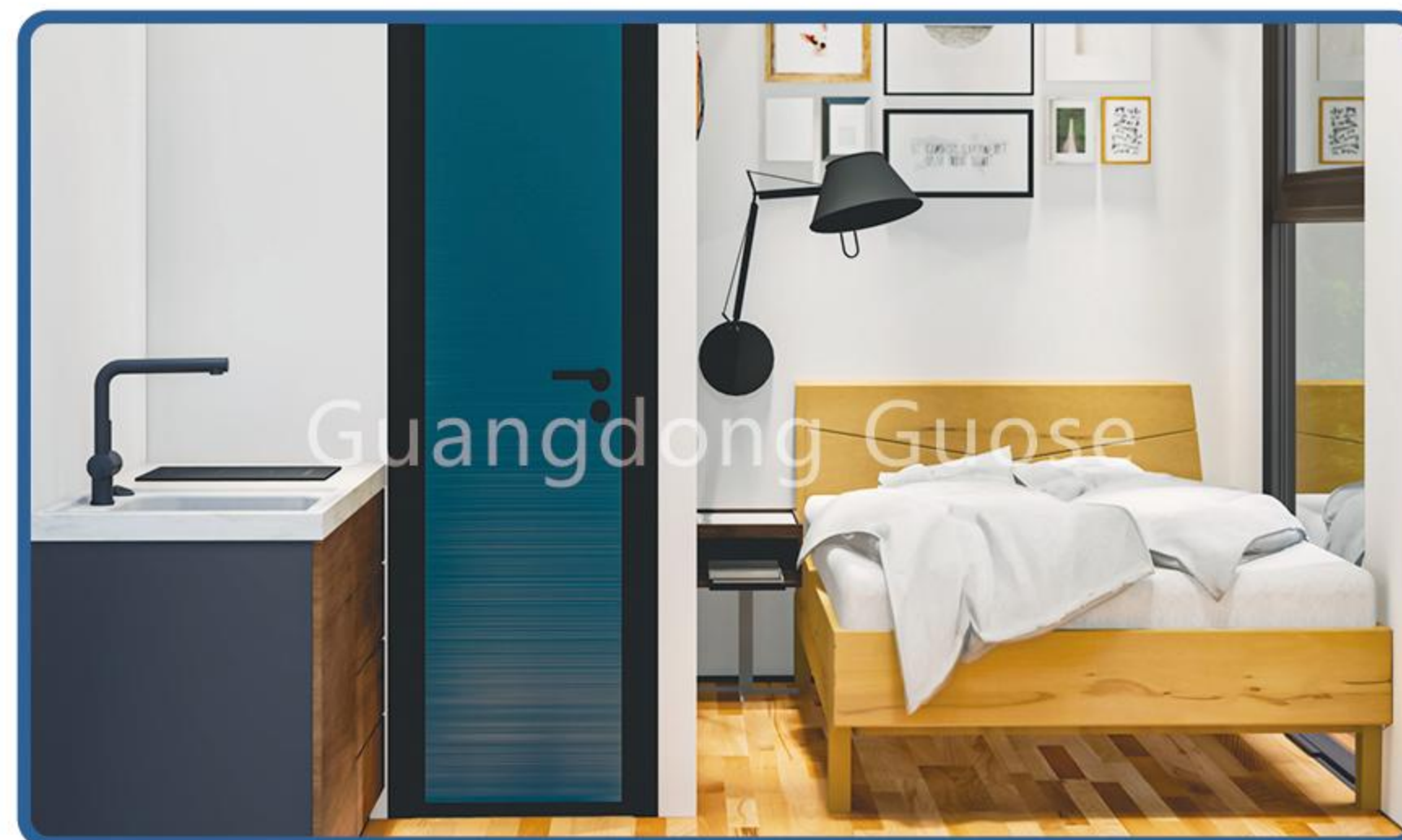

MH00 Modular House

Product size: 4000 x 3000 x 3000mm

Use area: 12 m²

Number of floors: 1 floor

Layout: One bedroom, one kitchen, one bathroom

Number of users: 2-3 people

MODULAR HOUSE-MH01

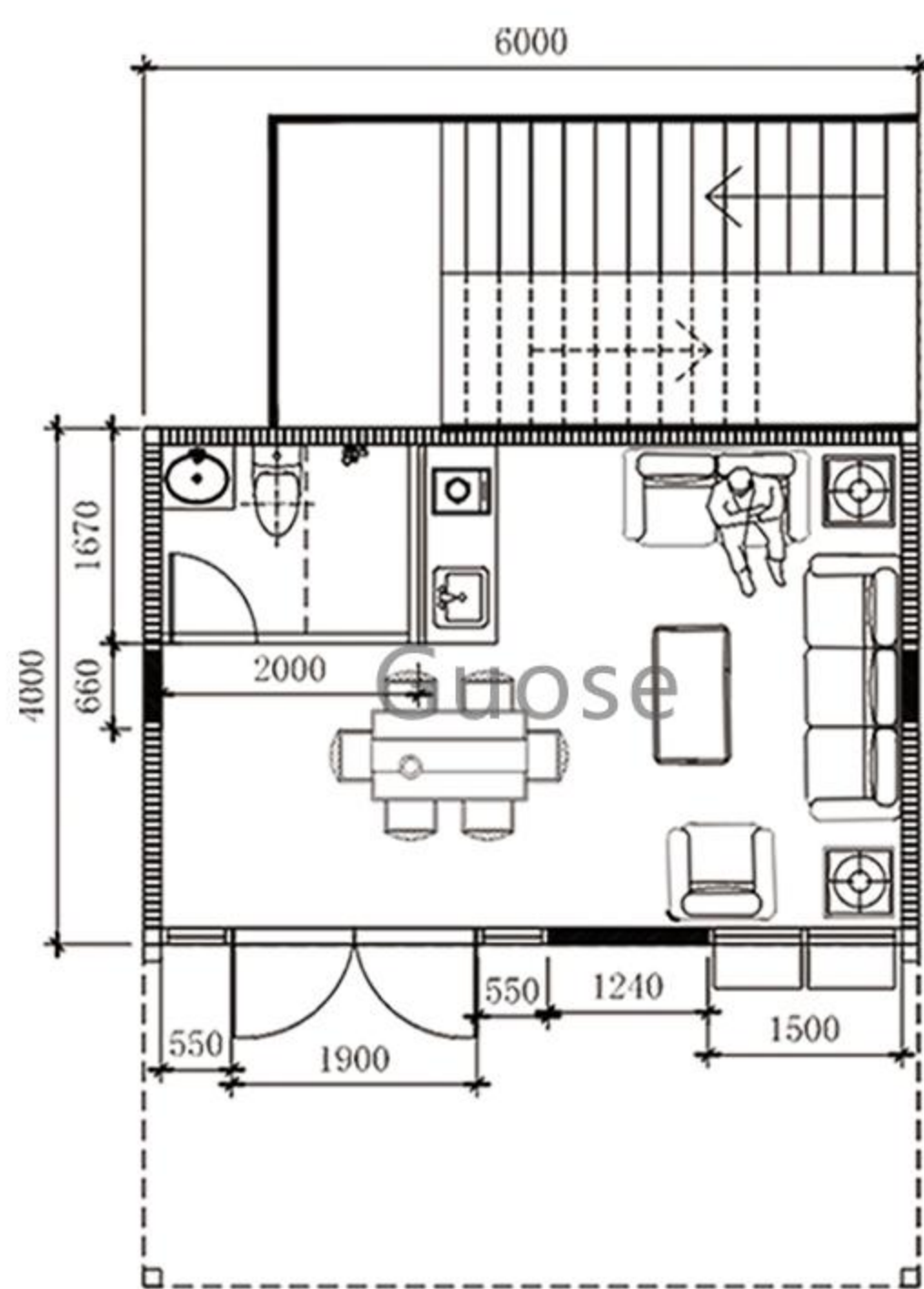
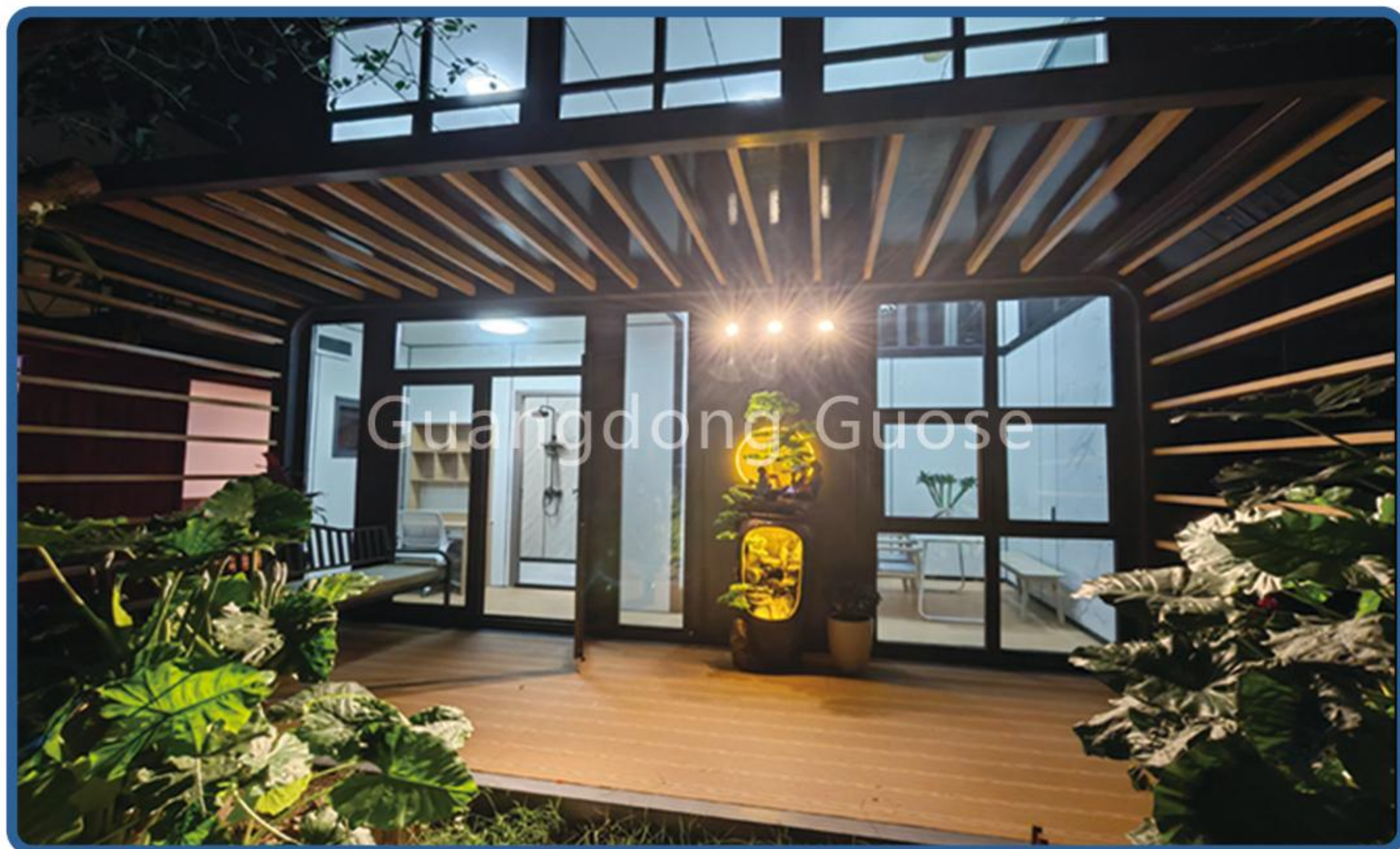

Floor Plan

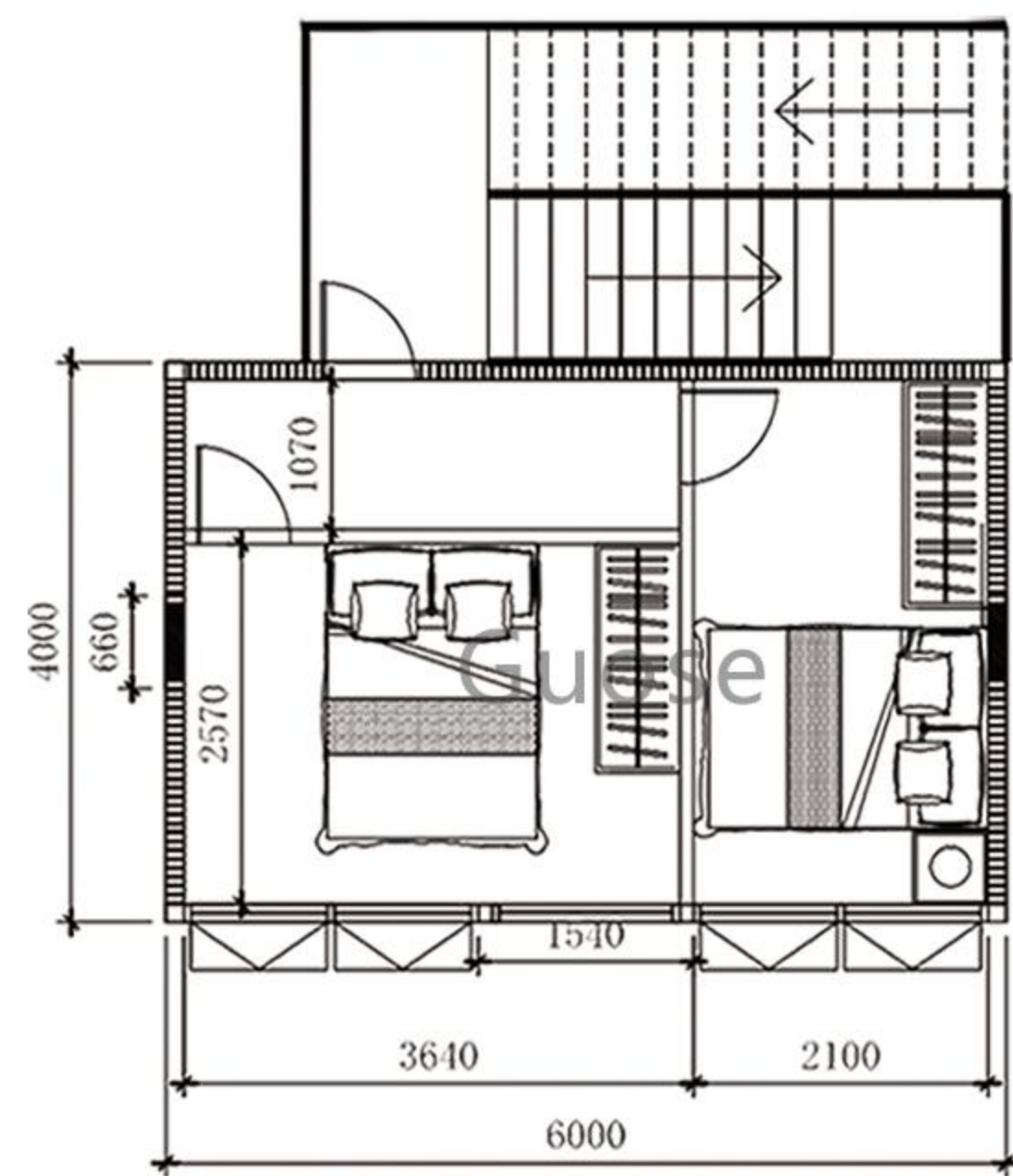

Second Floor Plan

MH01 Modular House

Product size: 6000 x 4000 x 5900mm

Use area: 48 m²

Number of floors: 2 floors

Layout: Two bedrooms, one bathroom,
one kitchen and one living room

Number of users: 4-6 people

MODULAR HOUSE-MH02

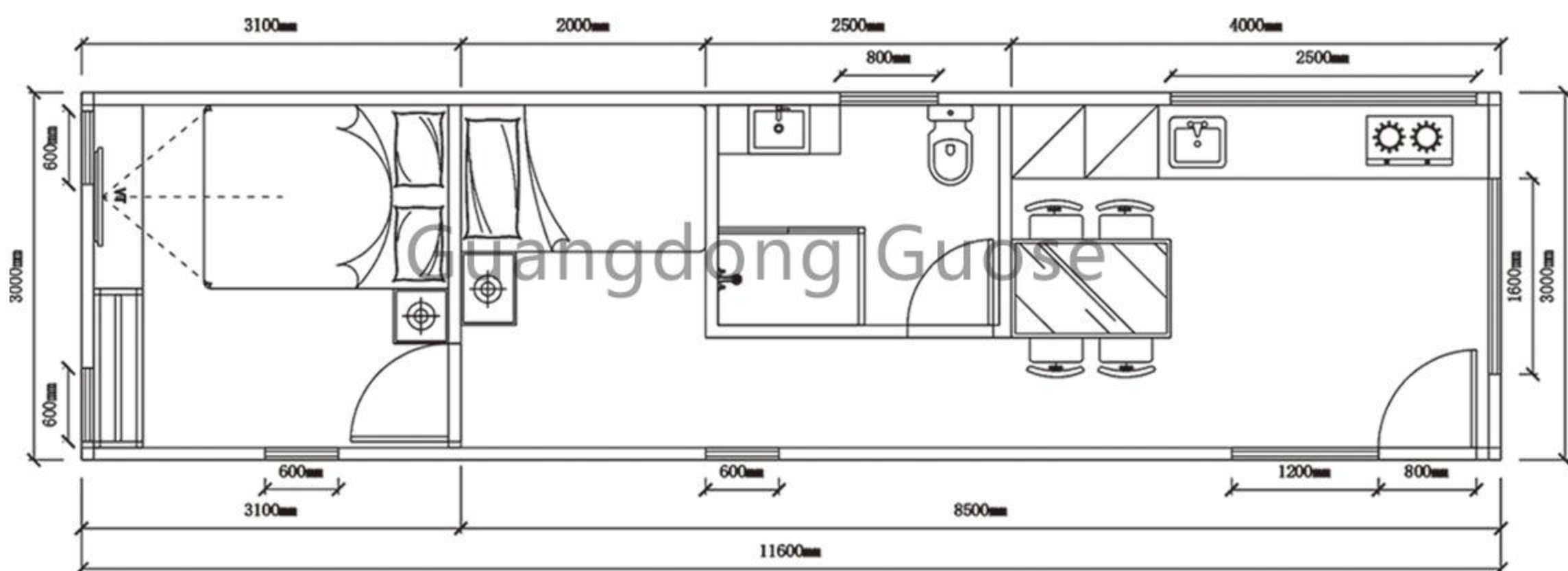

MH02 Modular House

Product size: 11600 x 3000 x 3000mm

Use area: 34.8 m²

Number of floors: 1 floor

Layout: One bedroom, one living room, one kitchen and one bathroom

Number of users: 3-4 people

MODULAR HOUSE-MH03

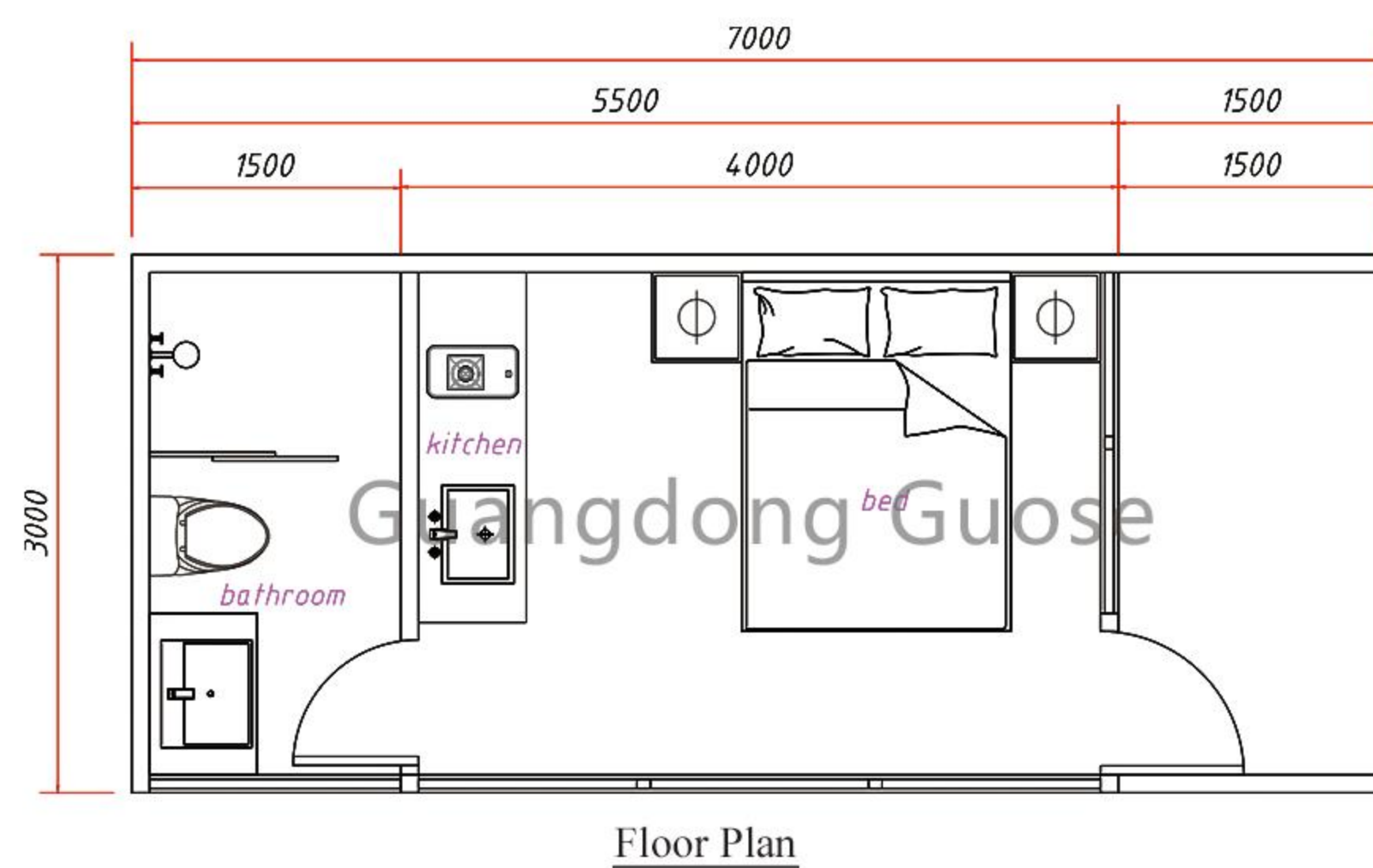

MH03 Modular House

Product size: 7000 x 3000 x 2450mm

Use area: 21 m²

Number of floors: 1 floor

Layout: One bedroom, one kitchen and one bathroom

Number of users: 2-3 people



MODULAR HOUSE-MH05

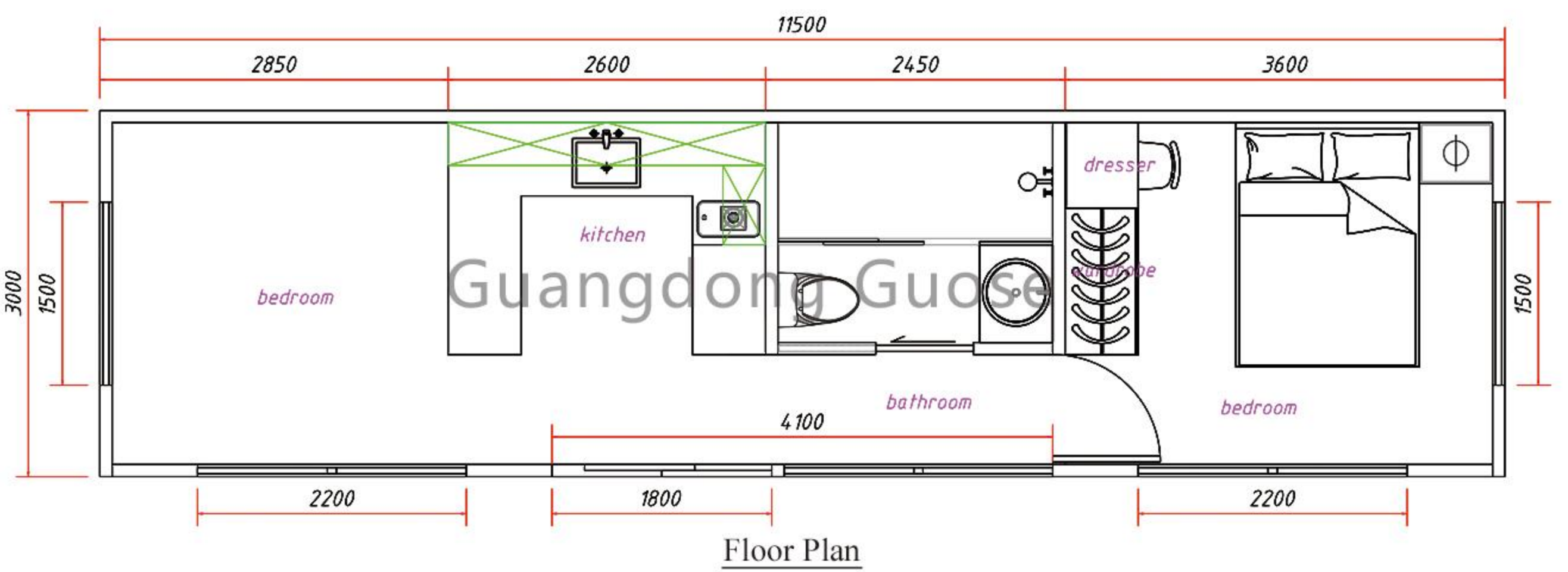

MH05 Modular House

Product size: 115000 x 3000 x 2450mm

Use area: 34.5 m²

Number of floors: 1 floor

Layout: Two bedroom, one kitchen, one bathroom

Number of users: 4-6 people



MODULAR HOUSE-MH06

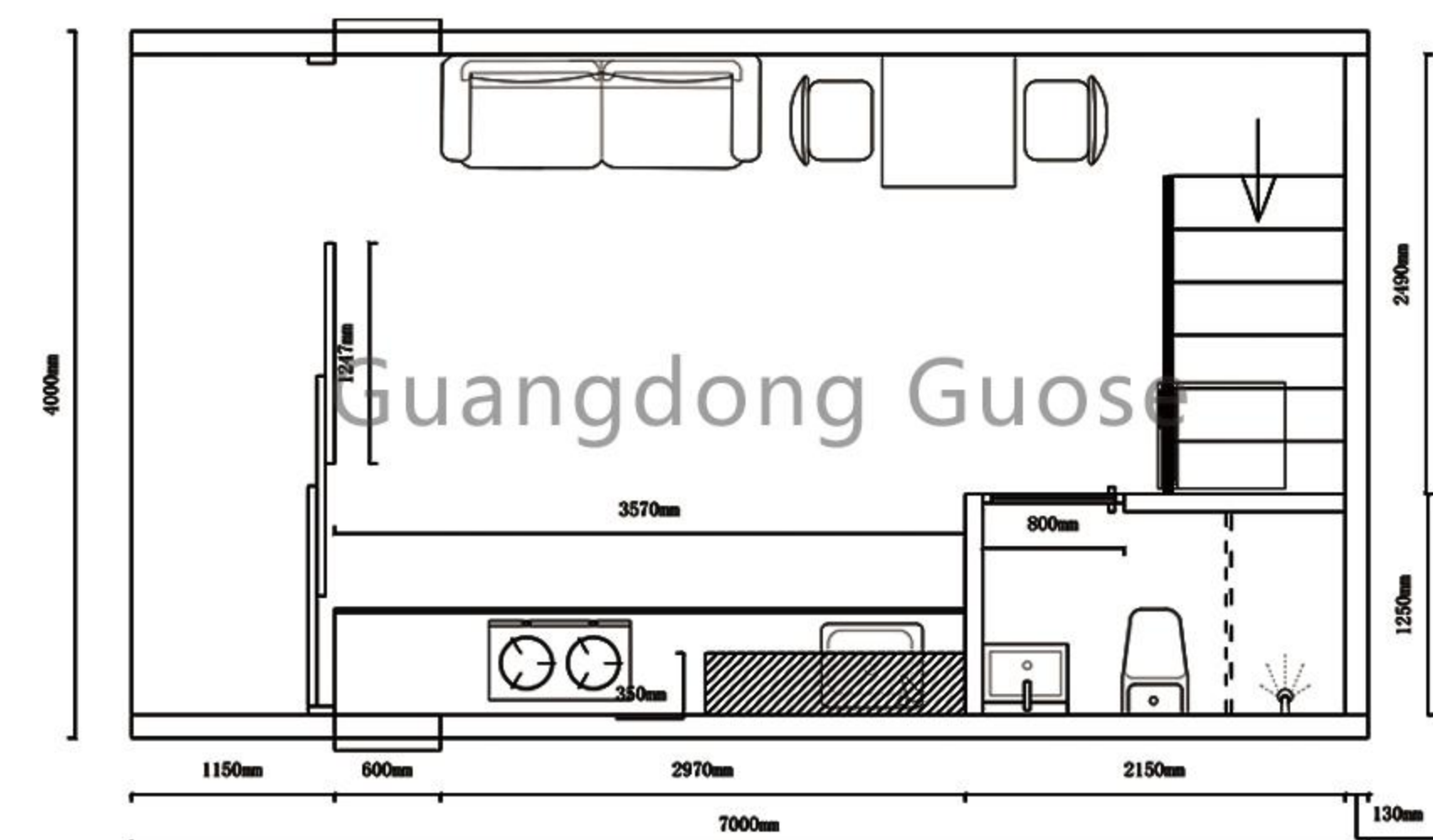

Floor Plan

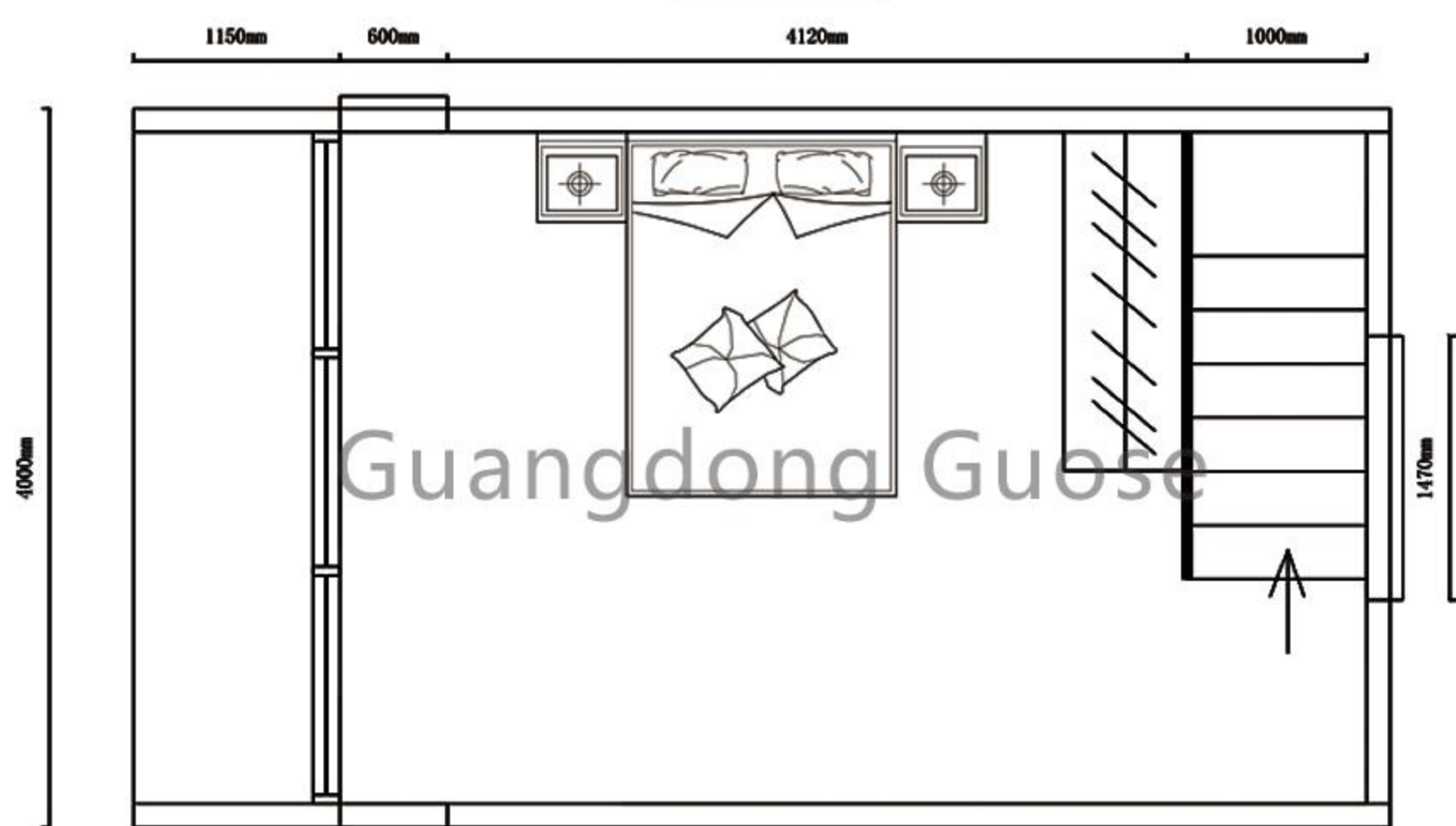

Second Floor Plan



MH06 Modular House

Product size: 7000 x 4000 x 5000mm

Use area: 56 m²

Number of floors: 2 floors

Layout: One bedroom, one kitchen ,
one bathroom,one living room

Number of users: 2-4 people

MODULAR HOUSE-MH07

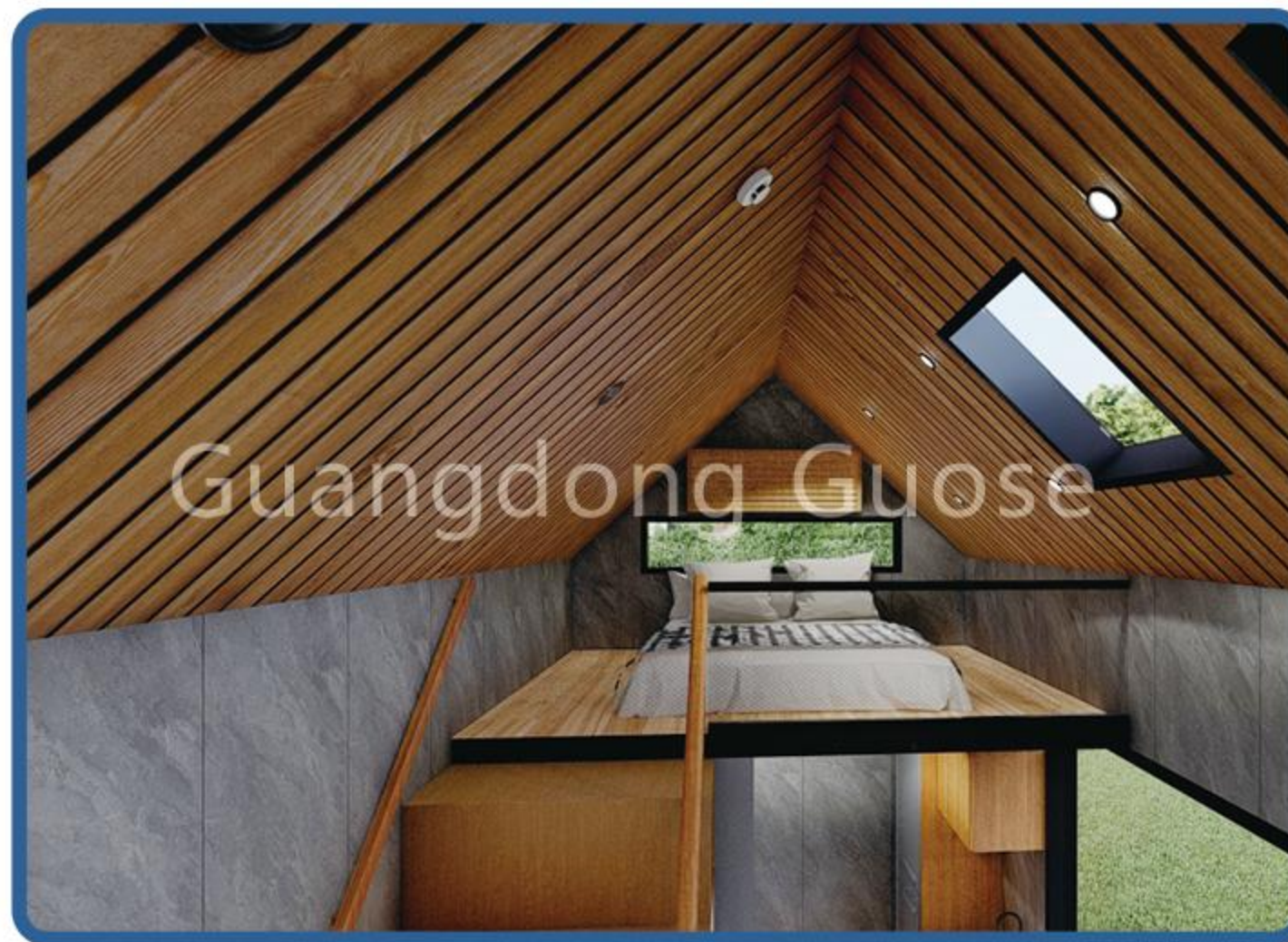
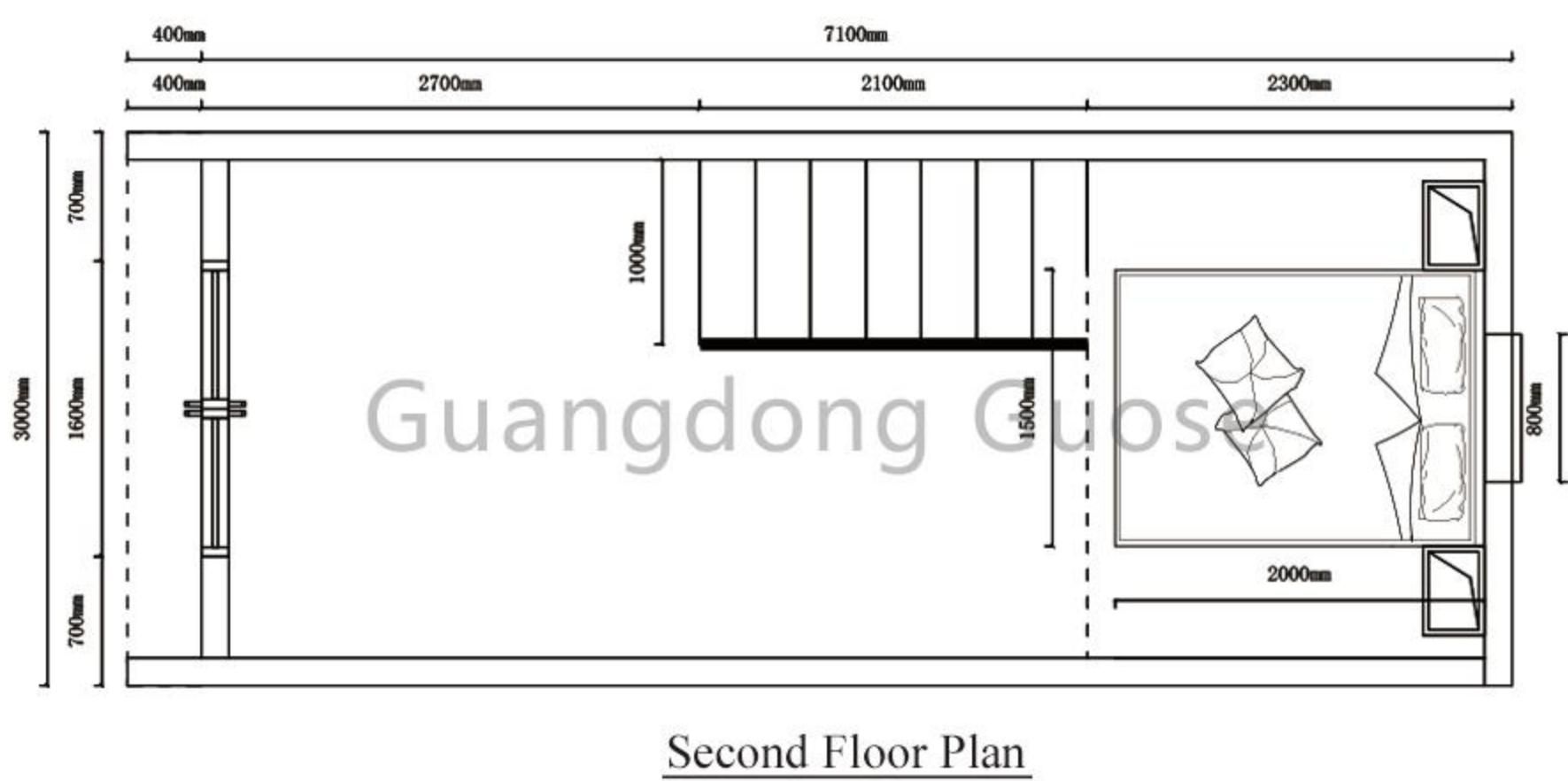
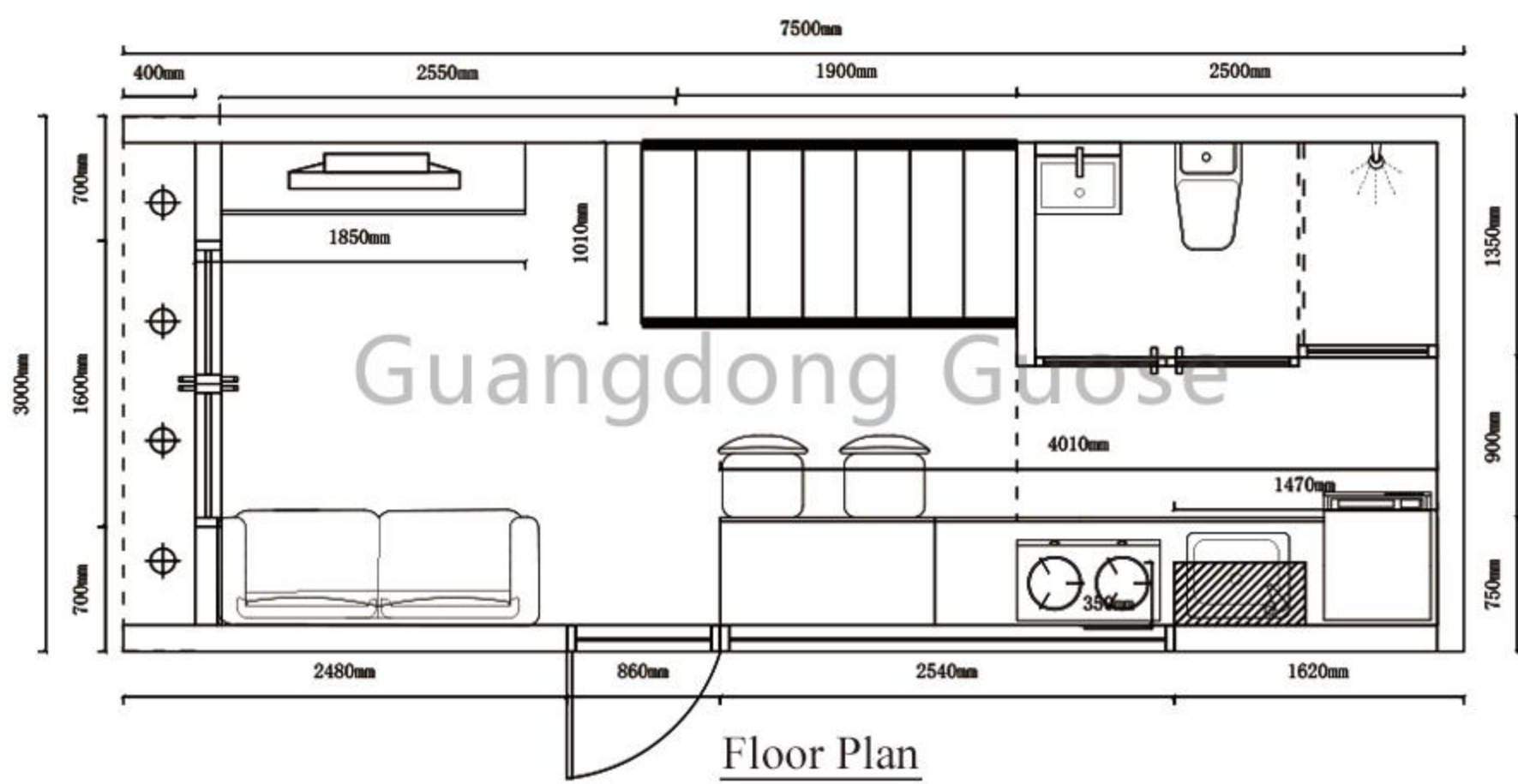

MH07 Modular House

Product size: 7500 x 3000 x 4600mm

Use area: 29.4 m²

Number of floors: 2 floors

Layout: One bedroom, one kitchen, one bathroom, one living room

Number of users: 2-4 people



小红书



抖音



微信公众号



INSTAGRAM

Guangdong Goose Building Technology Group Co., LTD

GUANGZHOU OFFICE ADDRESS : Room 311, Huayue Building, 423 Xicha Road, Baiyun District, Guangzhou City, Guangdong Province

FACTORY ADDRESS : No. 21, Linjiang Avenue, Yong'an Industrial Park, Dinghu District, Zhaoqing City, Guangdong Province

COMPANY CONTACT : SHIRLEY

CONTACT NUMBER : +86-13512762486