



BRD New Materials Co., Ltd.

WhatsApp: +86 18638188782

Website: www.brdecogroup.com

Factory Address: Wei Wu Avenue, Industrial Cluster Zone,
Changge, Henan



SANDWICH PANEL SERIES

THE ADVOCATE OF GREEN,
ENVIRONMENT-FRIENDLY AND
ENERGY-SAVING BUILDING MATERIALS





Company profile

BRD New Materials Co., Ltd was founded in 1995 and located in Changge Industrial Agglomeration Area, Henan Province, is a modern joint-stock enterprise operating according to the requirements of publicly-listed company. Integrating scientific research, development, manufacturing, sales and service, BRD has professional manufacturing, technology, functional research and marketing team, committing to fostering one excellent enterprise in the application and development of decoration, energy-saving and other related products.

The main products include: integrated housing, steel structure, sandwich panel, external wall cladding system, steel truss deck and other mainstream building decoration supplies, system integration products. As a large new energy-saving building materials production base in China, BRD relies on the radiation of global marketing network to provide users with timely, meticulous and comprehensive services, and it strives to become a social and user-trusted global enterprise.

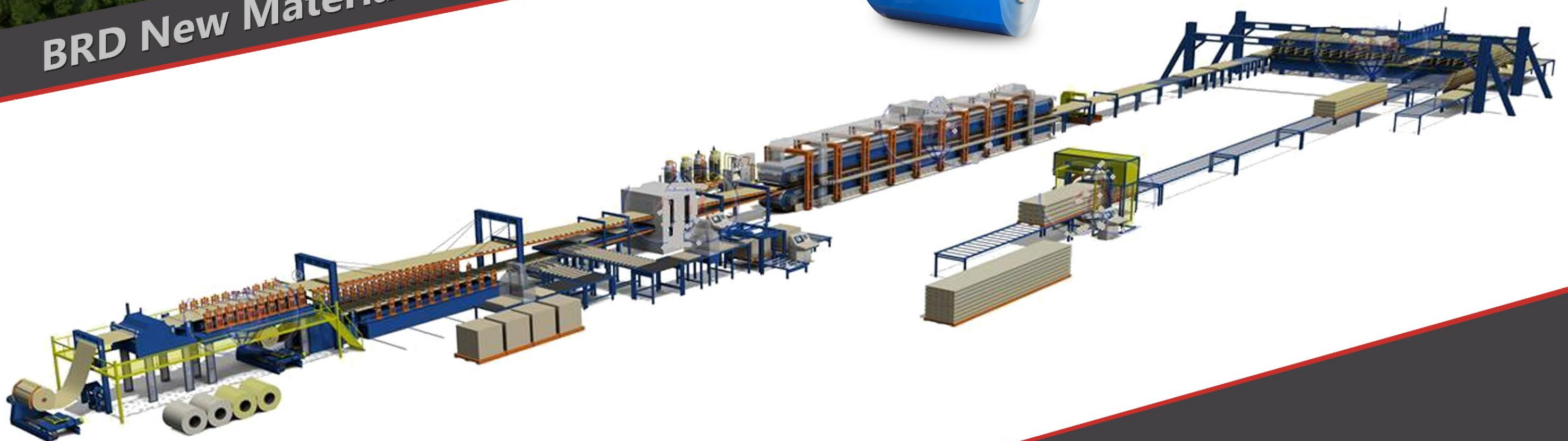
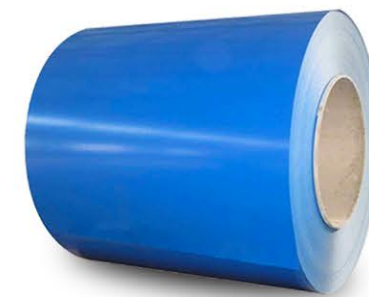

BRD PANEL SANDWICH PANEL

Sandwich Panel series produced by imported machine from Italy PUMA

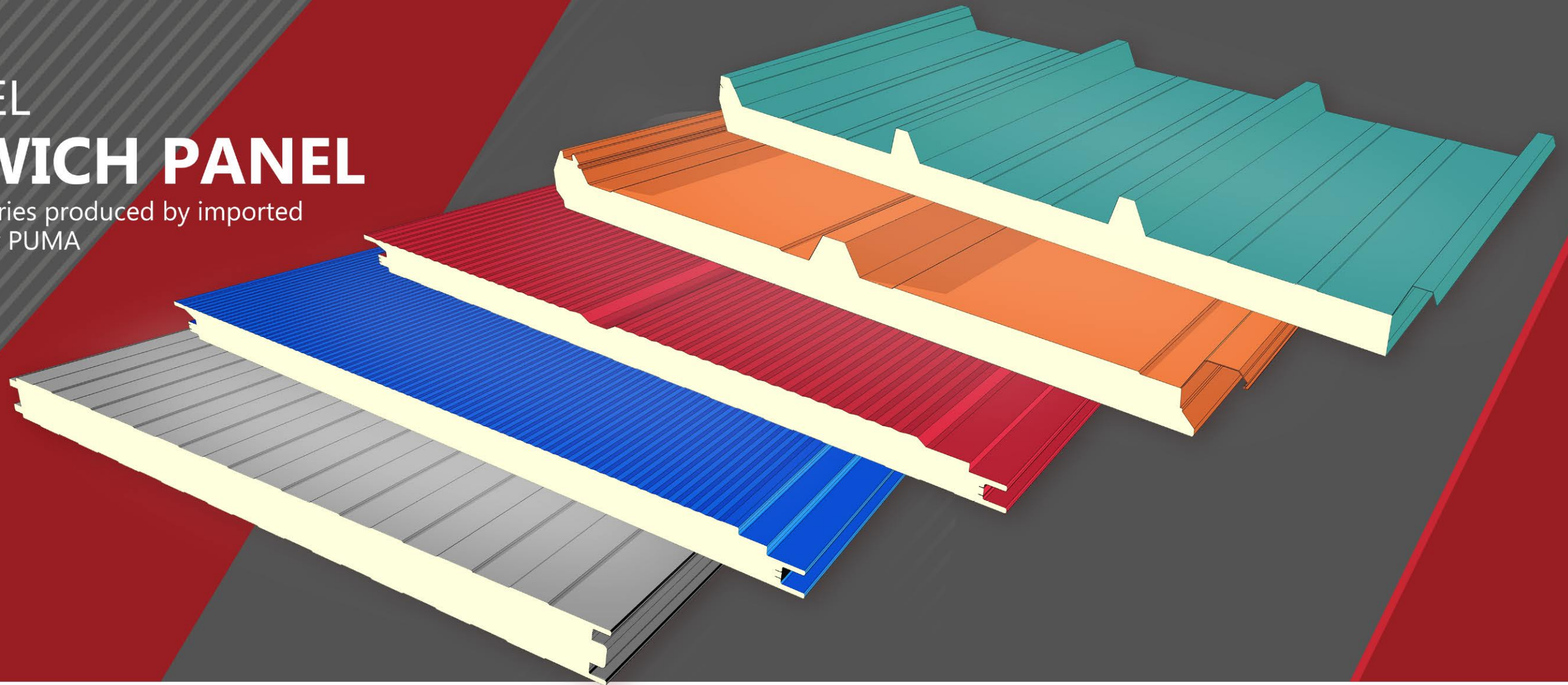

This is a perfect time for building material, used for insulation, light weight, durability, fire resistance, sound-proof building, it's benefits to the economy and customers, BRD Panel provide the convenient construction, creating a new energy saving building material product to contractors.



■ BRD-Small Wave PU Wall Panel

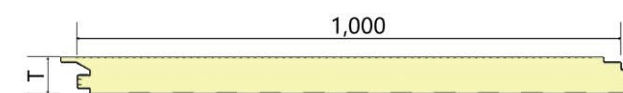

■ BRD-Mirror Surface PU Wall Panel

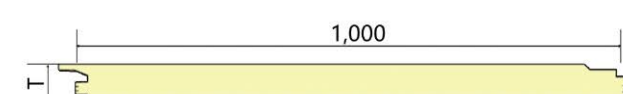

■ BRD-Concave PU Wall Panel

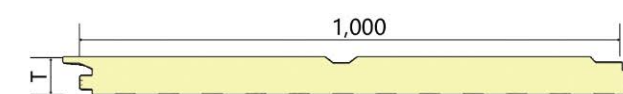

■ BRD-Three Waves PU Sandwich Roof Panel

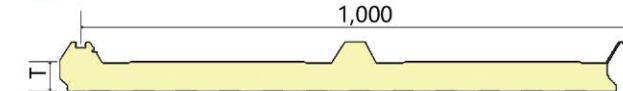

■ BRD-Four Waves PU Roof Panel

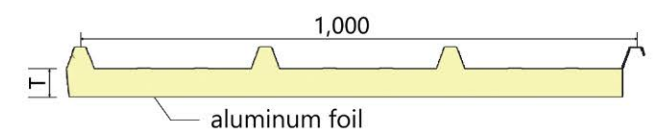

■ BRD-PU Cold Room Panel-01

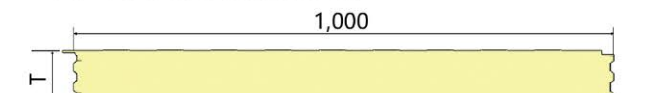

■ BRD-PU Cold Room Panel-02

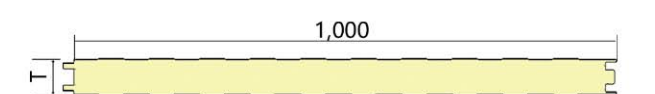

■ BRD-PU Cold Room Panel-03

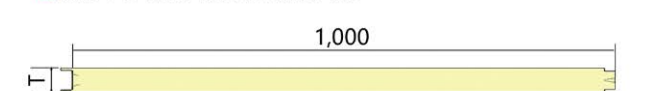

BRD Panel Aplicacion Application



BRD sandwich panel can meet all the building materials requirements for any building, as well as different cost and style in architectural designs.

Storage



Our building materials can be used to build a safe building to store goods that have achieved good insulation and humidity requirements. (grain warehouse, industrial plant, chemical laboratory, cold storage)

Building Cycle



BRD sandwich panel is a very environmentally friendly new building material. It has a warm proof and fireproof effect, and is easy to install, which can greatly shorten the building cycle.

Design



BRD sandwich panel can support a range of rain-screen finishes to compliment any architectural scheme.

Expansion



BRD sandwich panel can be used for building expansion and refurbishment.

Architecture



It can be used in large industrial plants, warehouses supermarkets, hospitals, stadiums, cold storage, activities room, buildings plus layer, clean workshop and heat insulation place.



Fireproof

BRD sandwich panel provide a fire resistive rating of up to three hours.



Customize

Available in multiple profiles, finishes and color options, trim less ends and cover widths, BRD sandwich panels provide customized building design and creative freedom.



Installation

BRD sandwich panel is easy to install, if you meet any question when you install it, we can give you the best solution about installation.



Design

BRD sandwich panel offer designers a comprehensive range of building solutions for vertical and horizontal wall applications.



High R-value

BRD sandwich panel offer superior R-values with unparalleled thermal performance during service life, all built-in to a single off-site, factory assembled insulated panel.



Maintenance Instruction

BRD sandwich panel offer the maintenance instruction, if you have some question when you used it, please contact us.



Superior Air-tightness and Weather-tightness

One of the biggest sources of building heat loss (or heat gain) is air leakage i.e. – “leaky buildings”. BRD sandwich panels are rigorously tested to ensure that they remain both airtight and weather-tight over the life of a building.



Durable

BRD sandwich panel used high quality core material, which has the high water-repellent rate. It can be used long time.

The Cases Show

PU Sandwich Panel

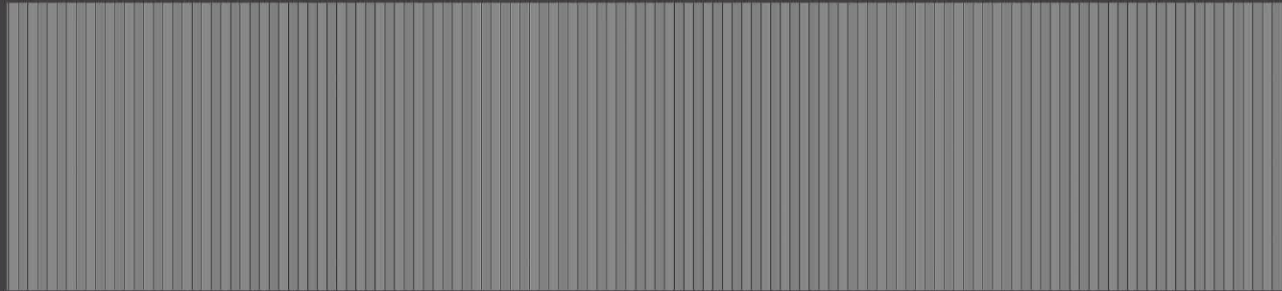

PU Sandwich Panel

Small Wave PU Wall Panel

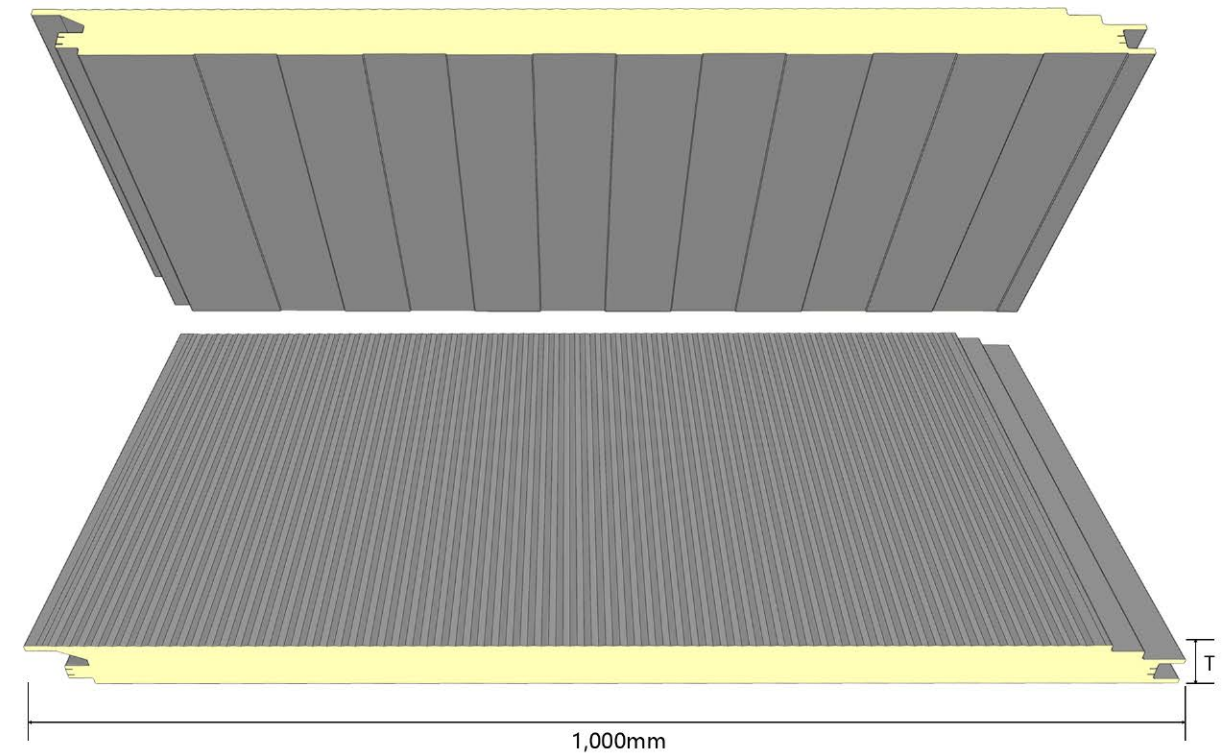

PU Sealing Rock Wool Sandwich Panel



PU Sealing Glass Wool Sandwich Panel



PU Sealing TPS Sandwich Panel

PU Sandwich Panel	Parameter Description
The Thickness of Steel Sheet	0.4-0.7mm
The Density of Core Material	40kg/m ³
The Thickness of Core Material	50mm/75mm/100mm/150mm/200mm
Colors	Any Ral Color
Thermal Conductivity (W/m.k)	≤0.025
The Way of Installation	1, horizontal 2, vertical
Compressive strength (kg/cm ²)	2.0-2.7



Seamless PU Wall Panel Interface



Sewed PU Wall Panel Interface

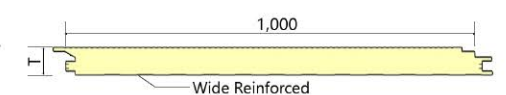

Wide Reinforced

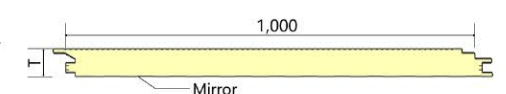

Mirror

The Cases Show

Sandwich Wall Panel



PU Sandwich Panel

Mirror PU Wall Panel

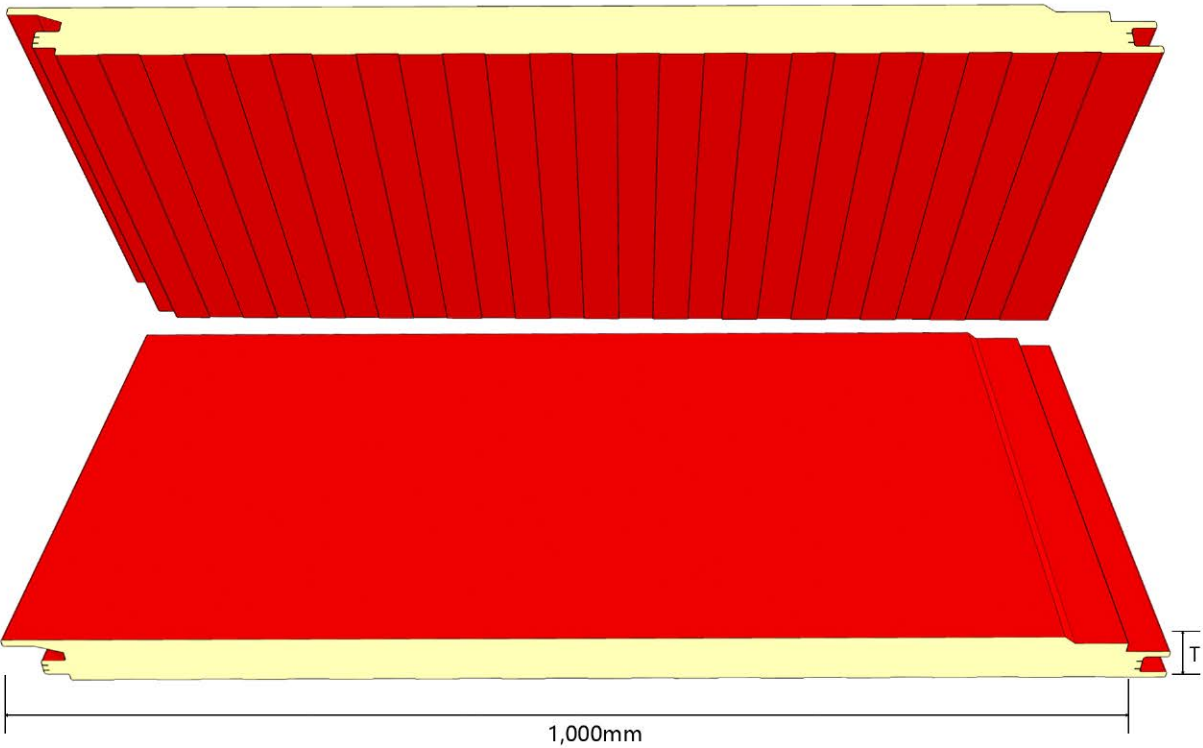

PU Sandwich Panel	Parameter Description
The Thickness of Steel Sheet	0.4-0.7mm
The Density of Core Material	40kg/m³
The Thickness of Core Material	50mm/75mm/100mm/150mm/200mm
Colors	Any Ral Color
Thermal Conductivity (W/m.k)	≤0.025
The Way of Installation	1, horizontal 2, vertical
Compressive strength (kg/cm²)	2.0-2.7

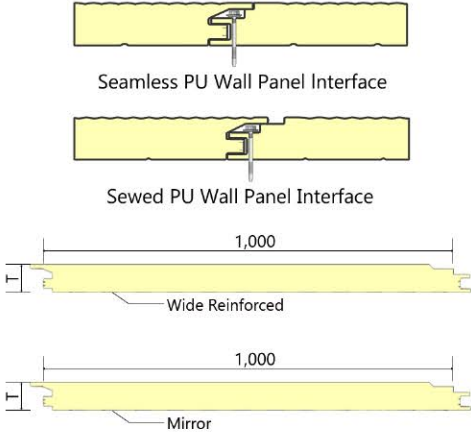

The Cases Show

Sandwich Wall Panel



PU Sandwich Panel

Concave PU Wall Panel

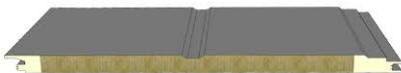
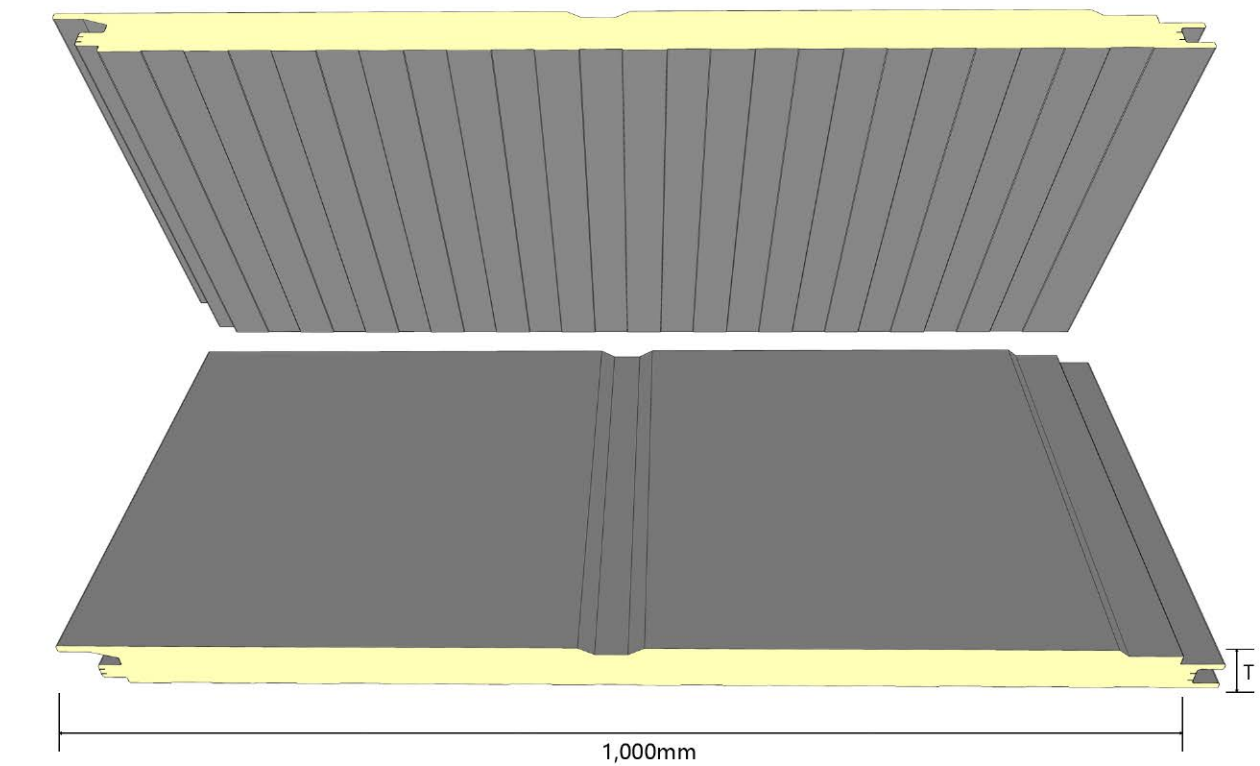

PU Sealing Rock Wool Sandwich Panel

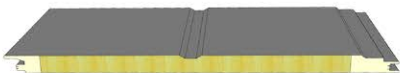

PU Sealing Glass Wool Sandwich Panel



PU Sealing TPS Sandwich Panel

PU Sandwich Panel	Parameter Description
The Thickness of Steel Sheet	0.4-0.7mm
The Density of Core Material	40kg/m³
The Thickness of Core Material	50mm/75mm/100mm/150mm/200mm
Colors	Any Ral Color
Thermal Conductivity (W/m.k)	≤0.025
The Way of Installation	1, horizontal 2, vertical
Compressive strength (kg/cm²)	2.0-2.7

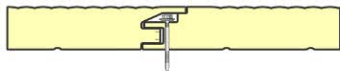

Seamless PU Wall Panel Interface

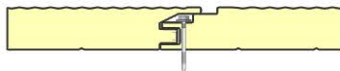

Sewed PU Wall Panel Interface

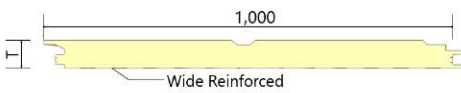

Wide Reinforced

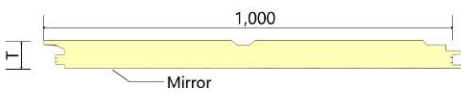

Mirror

The Cases Show

Sandwich Roof Panel



Three Waves PU Sandwich

Roof Panel

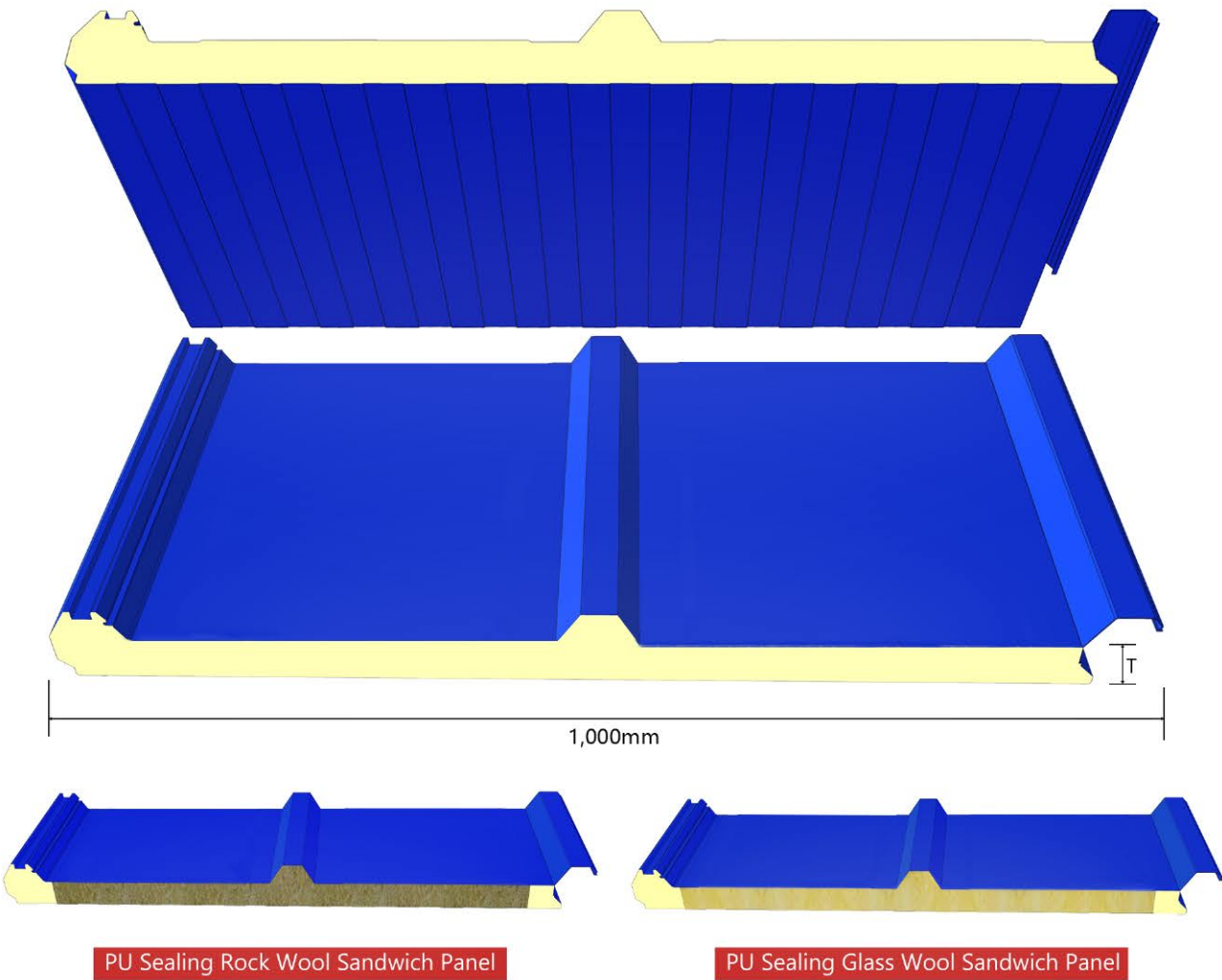

PU Sandwich Panel	Parameter Description
The Thickness of Steel Sheet	0.4-0.7mm
The Density of Core Material	40kg/m³
The Thickness of Core Material	50mm/75mm/100mm
Colors	Any Ral Color
Thermal Conductivity (W/m.k)	≤0.023
The Way of Installation	1, horizontal 2, vertical
Compressive strength (kg/cm²)	2.0-2.7

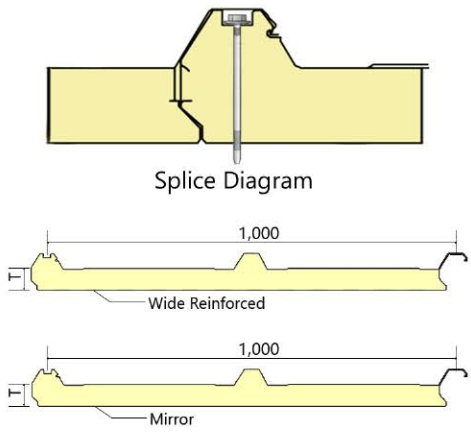

The Cases Show

4 Waves Roof Panel



Four Waves PU Sandwich Roof Panel

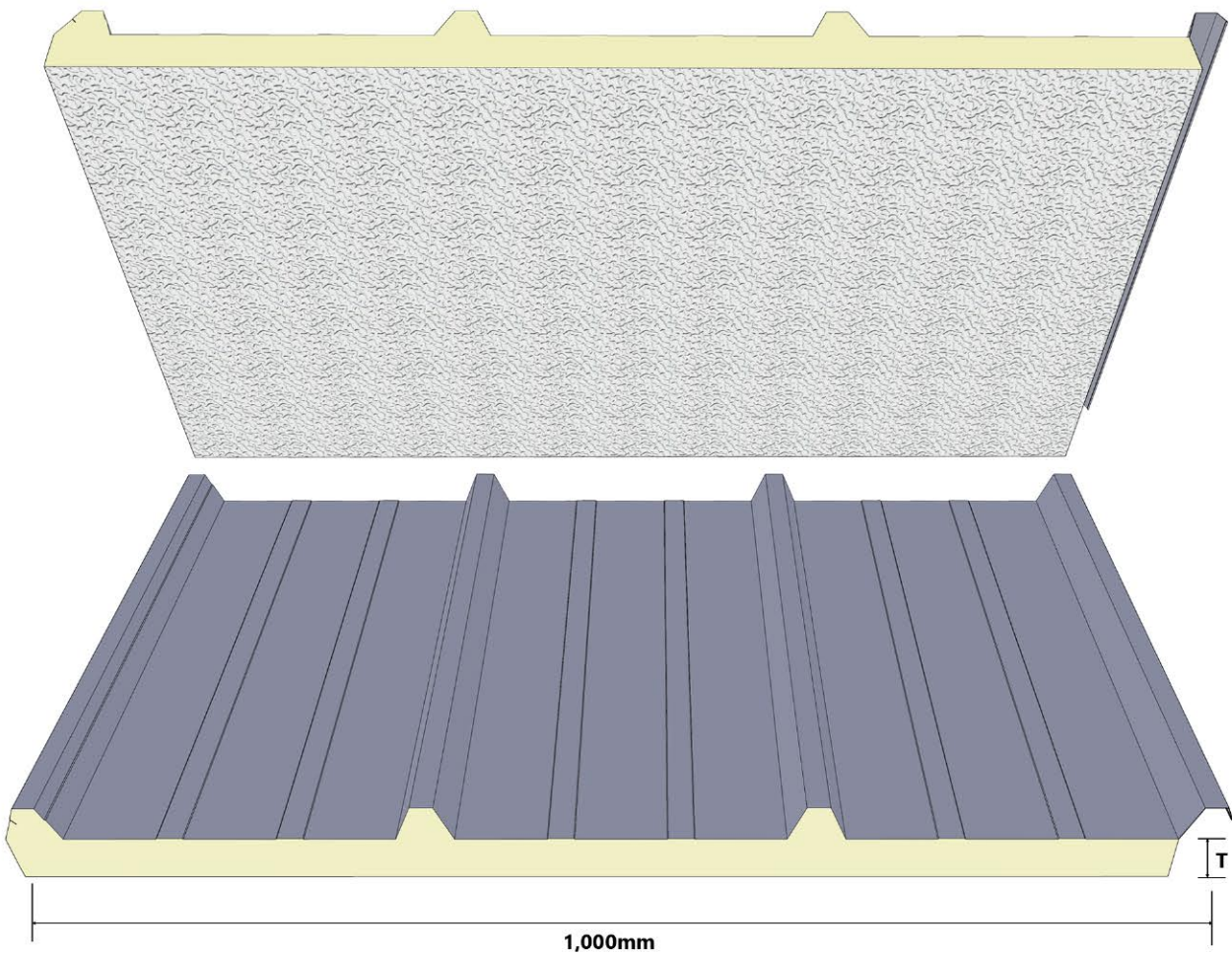

PU Sandwich Panel	Parameter Description
The Thickness of Steel Sheet	0.4-0.7mm
The Density of Core Material	40kg/m³
The Thickness of Core Material	60mm
Colors	Any Ral Color
Thermal Conductivity (W/m.k)	≤0.023
The Way of Installation	1, horizontal 2, vertical
Compressive strength (kg/cm²)	2.0-2.7

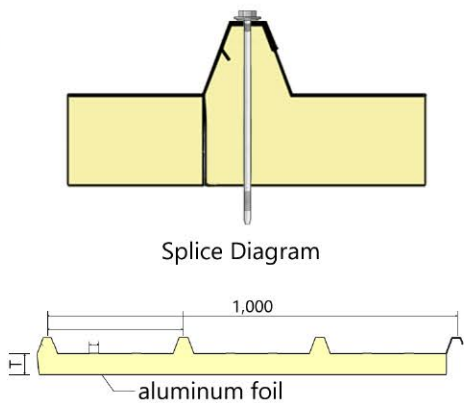

The Cases Show

Cold Room Panel



PU Cold Room Panel

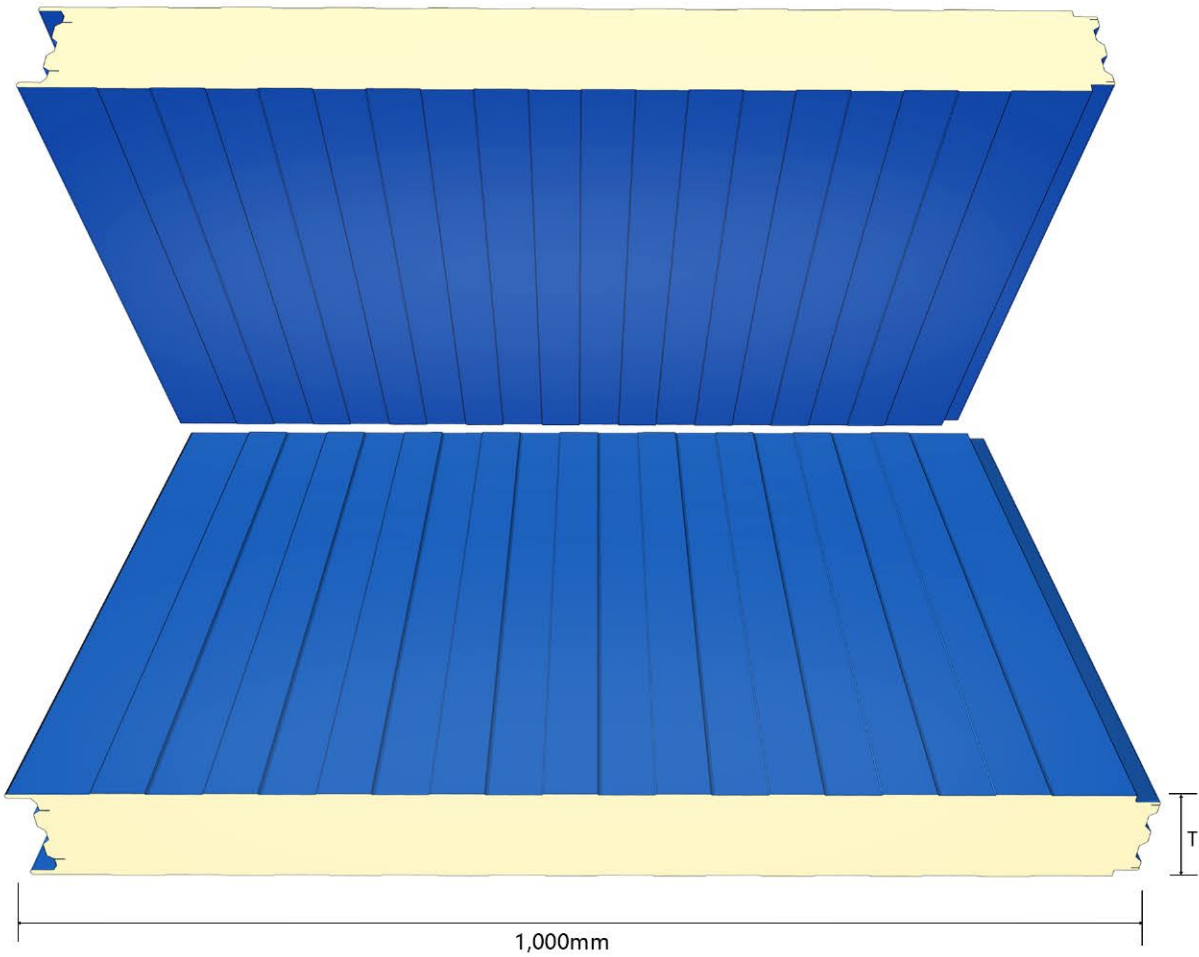

PU Sandwich Panel	Parameter Description
The Thickness of Steel Sheet	0.4-0.7mm
The Density of Core Material	40kg/m³
The Thickness of Core Material	50mm/75mm/100mm/150mm/200mm
Colors	Any Ral Color
Thermal Conductivity (W/m.k)	≤0.023
The Way of Installation	1, horizontal 2, vertical
Compressive strength (kg/cm²)	2.0-2.7

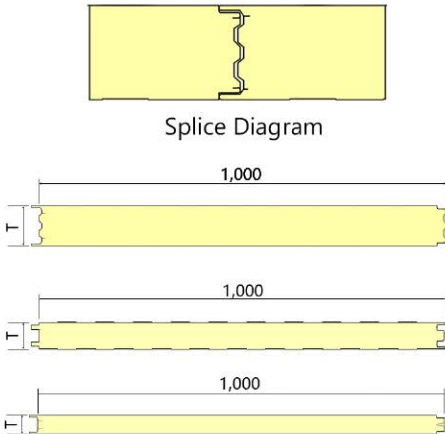

BRD Panel
Clean Room Panel Series

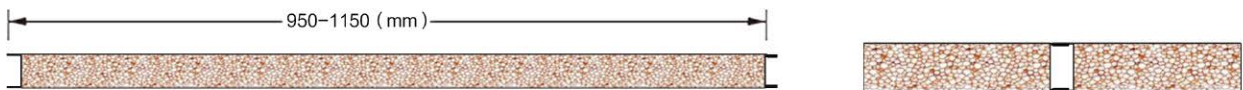
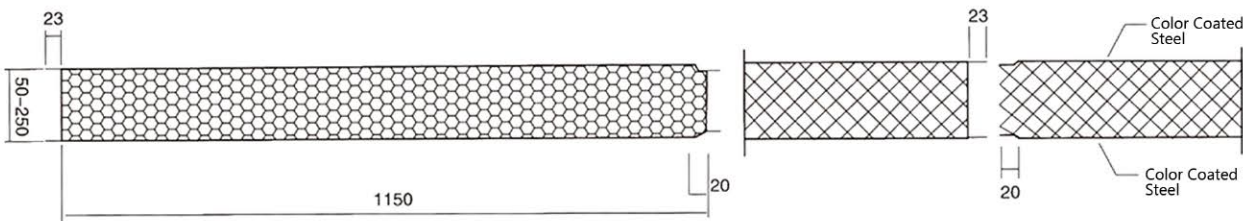

Horizontal Point

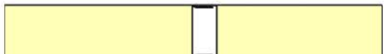
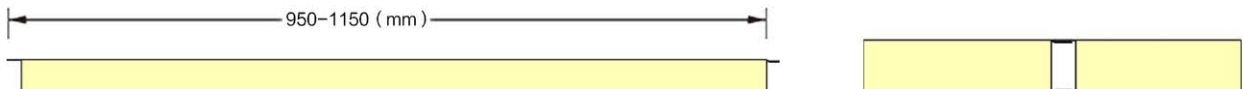

Horizontal Point



Horizontal Point



Gypsum Rock Wool Gypsum Aluminum Honeycomb Gypsum Aluminum Honeycomb Paper Honeycomb Pophen Magnesium Sulfide

Application

①
Cold Storage System



②
Steel Structure Maintenance System



③
Purification System



④
Silencing System



⑤
Painting System





BRD Panel EPS Sandwich Panel

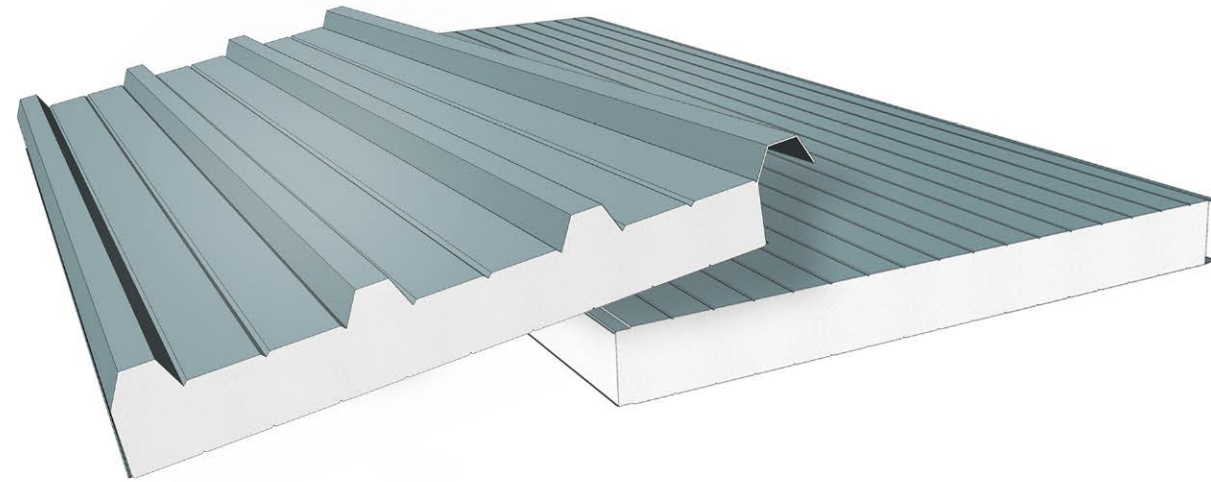

Heat and sound insulation. Temperature suitable for eps sandwich panel ranges from -200 centigrade to 150 centigrade.
Waterproof, anti-corrosion, good chemical resistance, insect-free etc.
Advanced Tech: Automatic Italian rolling machines make the whole process of manufacture effective.
Energy conservation, environmental protection, economical, heat insulating, good structure, easy-doing construction.
Light weight enough to reduce building expense.
Time can be saved on a building project due to the simple installation.

EPS	Parameter Description
Top Plate Thickness	0.4-0.7mm
Bottom Plate Thickness	0.4-0.7mm
Core material thickness	50mm/75mm/100mm/150mm/200mm
Type mode	980mm roof panel 950-1150mm wall panel
length	Less than 11.8m (for transport need)
Color	Any Ral Color
Side steel strip	Galvanized plate 0.4mm-0.7mm thick



BRD Panel PU Foam Insulation Panel

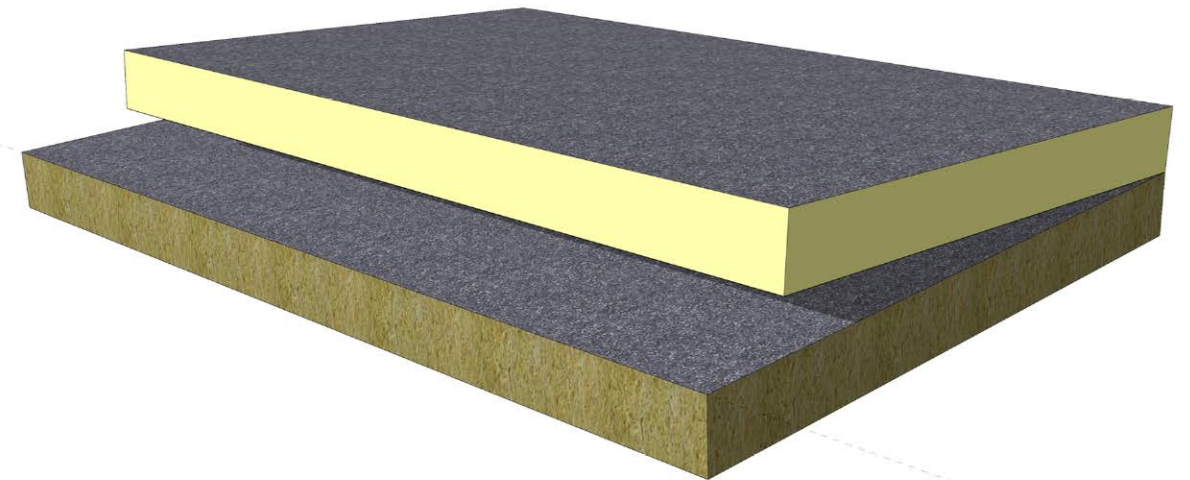

Characteristic as follows

- The outer surface of panel has kraft paper, glass fiber cloth, aluminum foil for selection.
- In a certain range, The panel's length, width and thickness are up to the customer's requirements.
- It has no harm to environment.
- The panel has no irritate the skin and respiratory system of construction workers.
- The panel is very waterproof, which is superior to rock wool and glass wool.









Item	Unit	Specification
Standard Panel Size	mm	3950*1200*20
Fireproof	grade	BS476 CLASS O
Alu. Foil Thickness	micron	80
Foam Density	kg/m³	40/50/60
Thermal Conductivity	w/m·k	0.02-0.025
Compressing Strength	Mpa	0.2
Water Absorption	%	≤0.1
Working Temperature	°C	-150 to +120

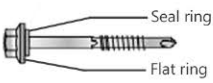

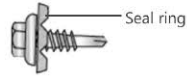
BRD Panel Attachments of Sandwich Panel



Flashing/ accessories

NAME	GRAPHICS	MATERIAL	SPECIFICATIONS
Top hat		Color Coated Steel	85×30
Self-tapping screw			
Waterproof rivet			
Stiching screw			
Roof backbone covering flashing		Color Coated Steel	
Internal roof backbone flashing		Color Coated Steel	
Add-on gutter brace		Color Coated Steel	
External corner flashing-11		Color Coated Steel	
Cornices flashing		Color Coated Steel	
Cornices flashing		Color Coated Steel	

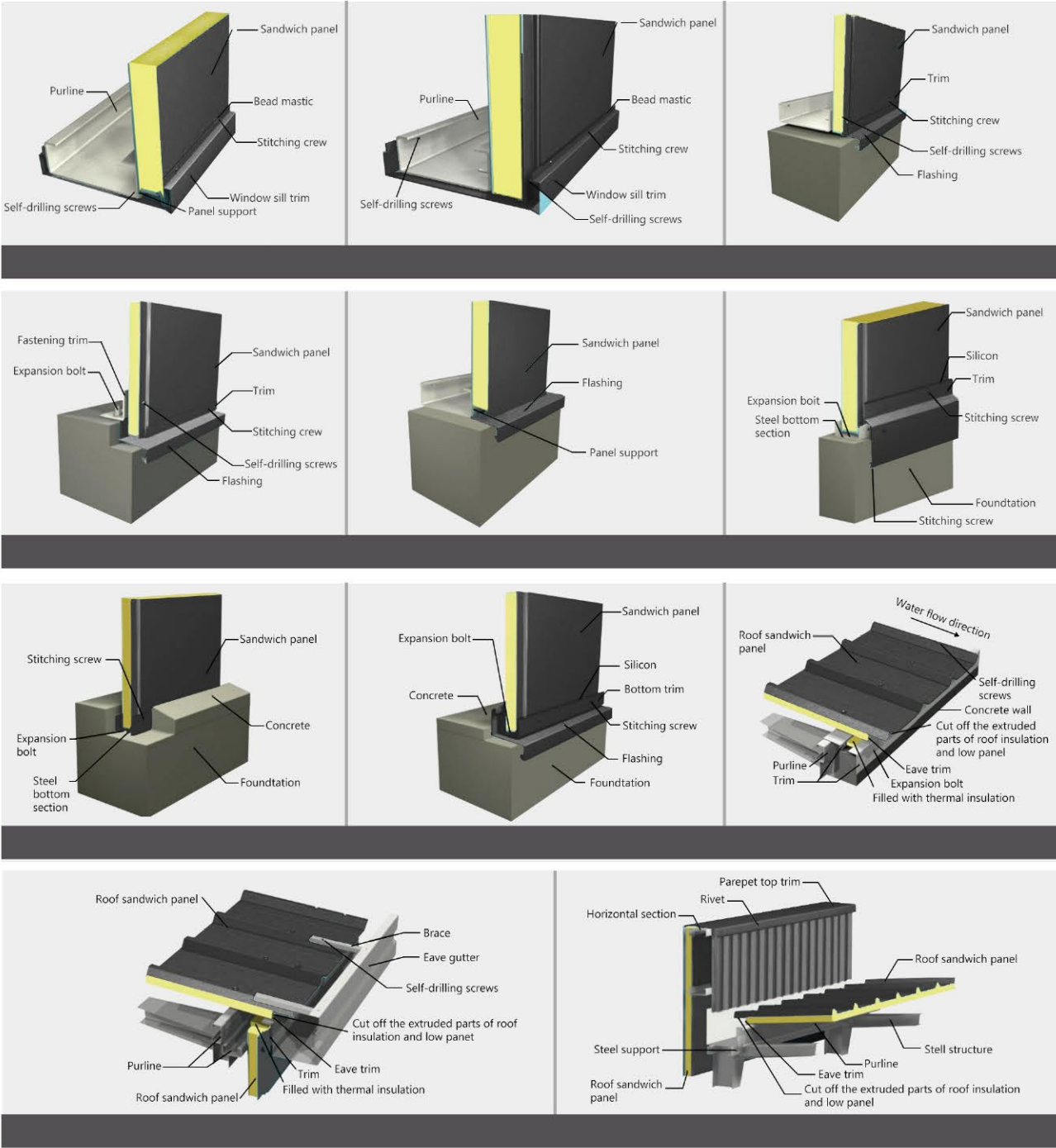

BRD Panel Loading and Unloading

- Key points of handling and stacking 10m long products.

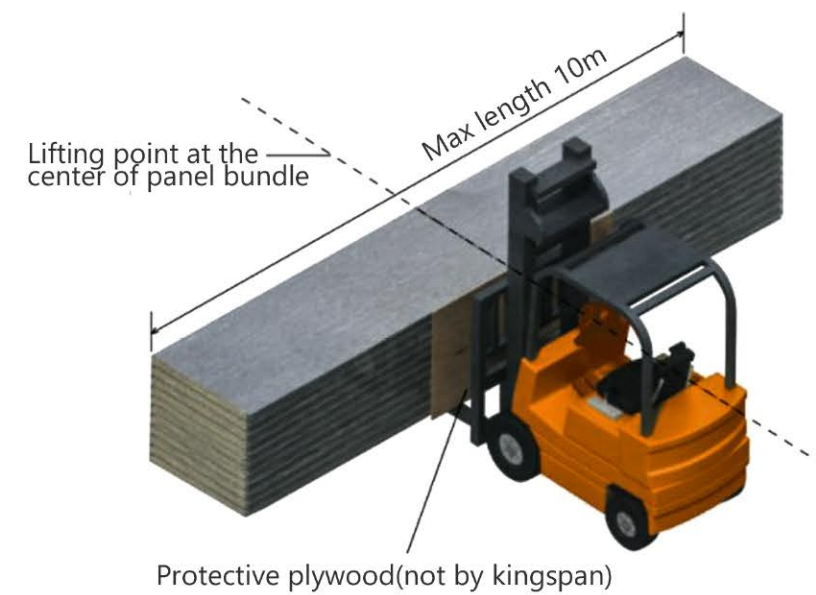

- When the panel length exceeding 10m, 2 forklifts needed to handle the panel. The distances between the panel center and two forklifts shall be the same.

